

1874 Survey of Upper Hutt district – Wellington to Wairarapa Railway Line

← South – North →

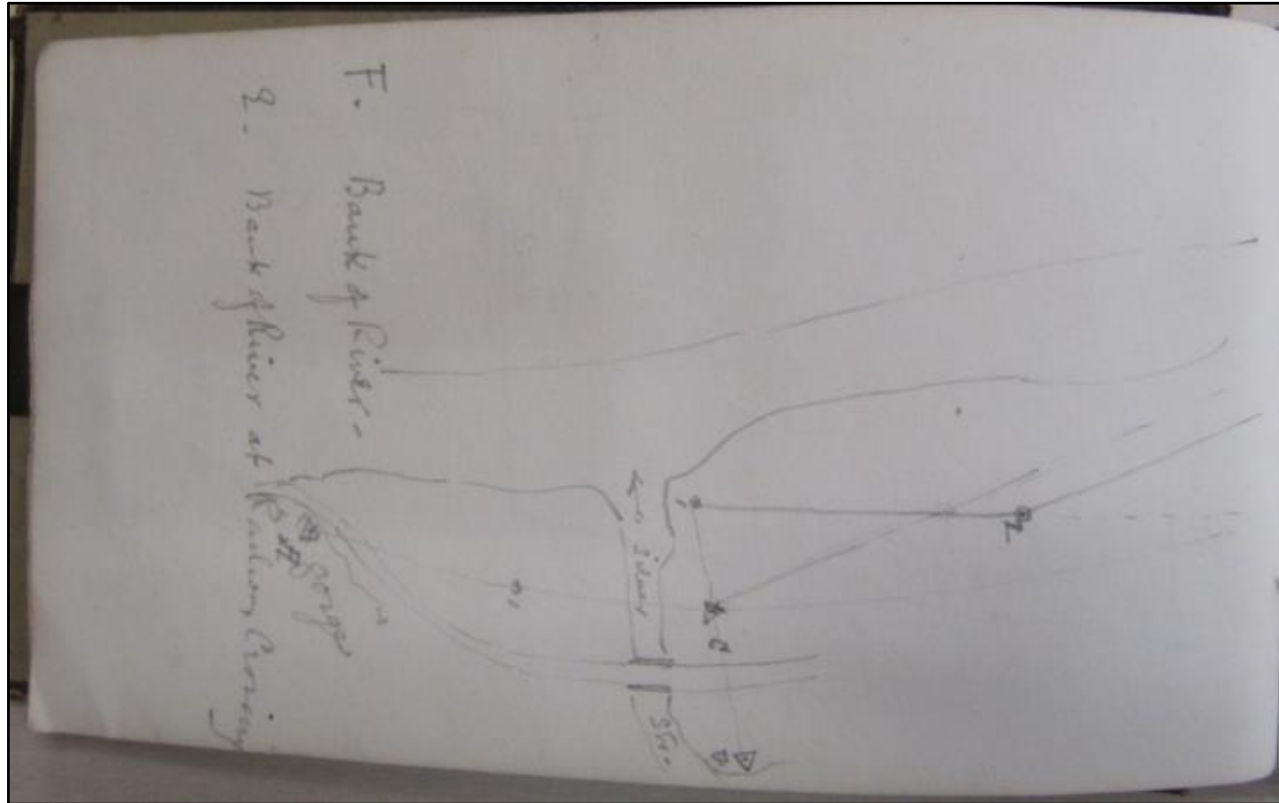

(Reference Archives NZ Wellington R22395531 AATE W3401 box 2 Surveyor Field Books [10 books] Wellington, Hutt, Masterton Railway JH Loh years 1874 - No 8 Silver Stream General Survey of Neighbourhood Railway Diversion Trail Survey Hutt River at Gorge to Smiths Round Hill Sides – J H Lowe Book 8 = images saved IMG_2476.jpg)

Top-west Section? – F=Bank of River – G=Bank of River at Railway Crossing - Gorge
Bottom–east Section? – Silver Stream – (perhaps a bridge over stream) -
Comments

1874 Survey of Upper Hutt district – Wellington to Wairarapa Railway Line

← - - - →

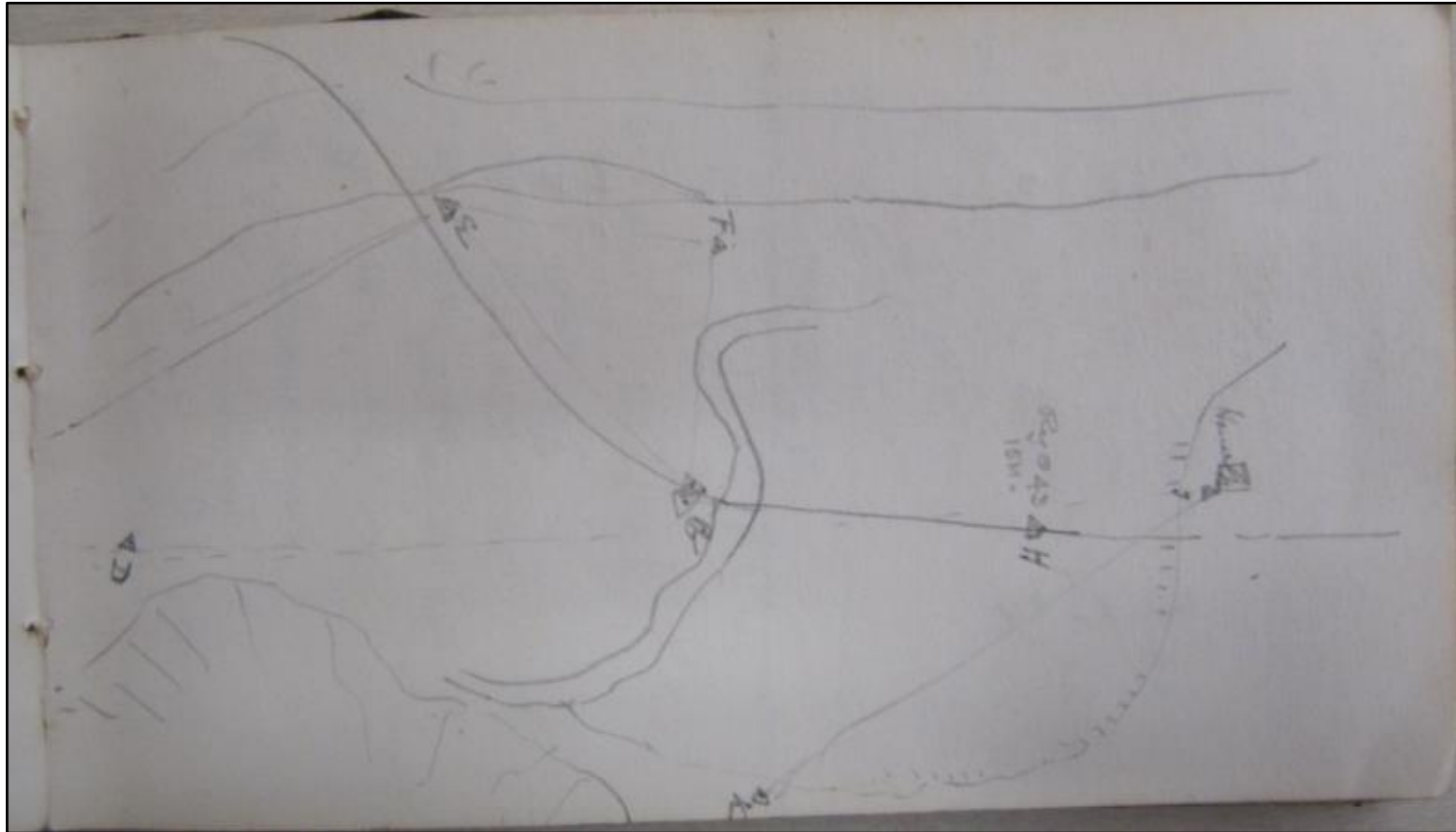

(Reference Archives NZ Wellington R22395531 AATE W3401 box 2 Surveyor Field Books [10 books] Wellington, Hutt, Masterton Railway JH Loh years 1874 - No 8 Silver Stream General Survey of Neighbourhood Railway Diversion Trail Survey Hutt River at Gorge to Smiths Round Hill Sides – J H Lowe Book 8 = images saved IMG_2477.jpg)

Middle Section? – House
Comments

1874 Survey of Upper Hutt district – Wellington to Wairarapa Railway Line

← -- →



(Reference Archives NZ Wellington R22395531 AATE W3401 box 2 Surveyor Field Books [10 books] Wellington, Hutt, Masterton Railway JH Loh years 1874 - No 8 Silver Stream General Survey of Neighbourhood Railway Diversion Trail Survey Hutt River at Gorge to Smiths Round Hill Sides – J H Lowe Book 8 = images saved IMG_2478.jpg)

Middle Section? – Upper Valley – Foot or fern Hill - Large white tree foot of hill -
Comments

1874 Survey of Upper Hutt district – Wellington to Wairarapa Railway Line

← South – North →

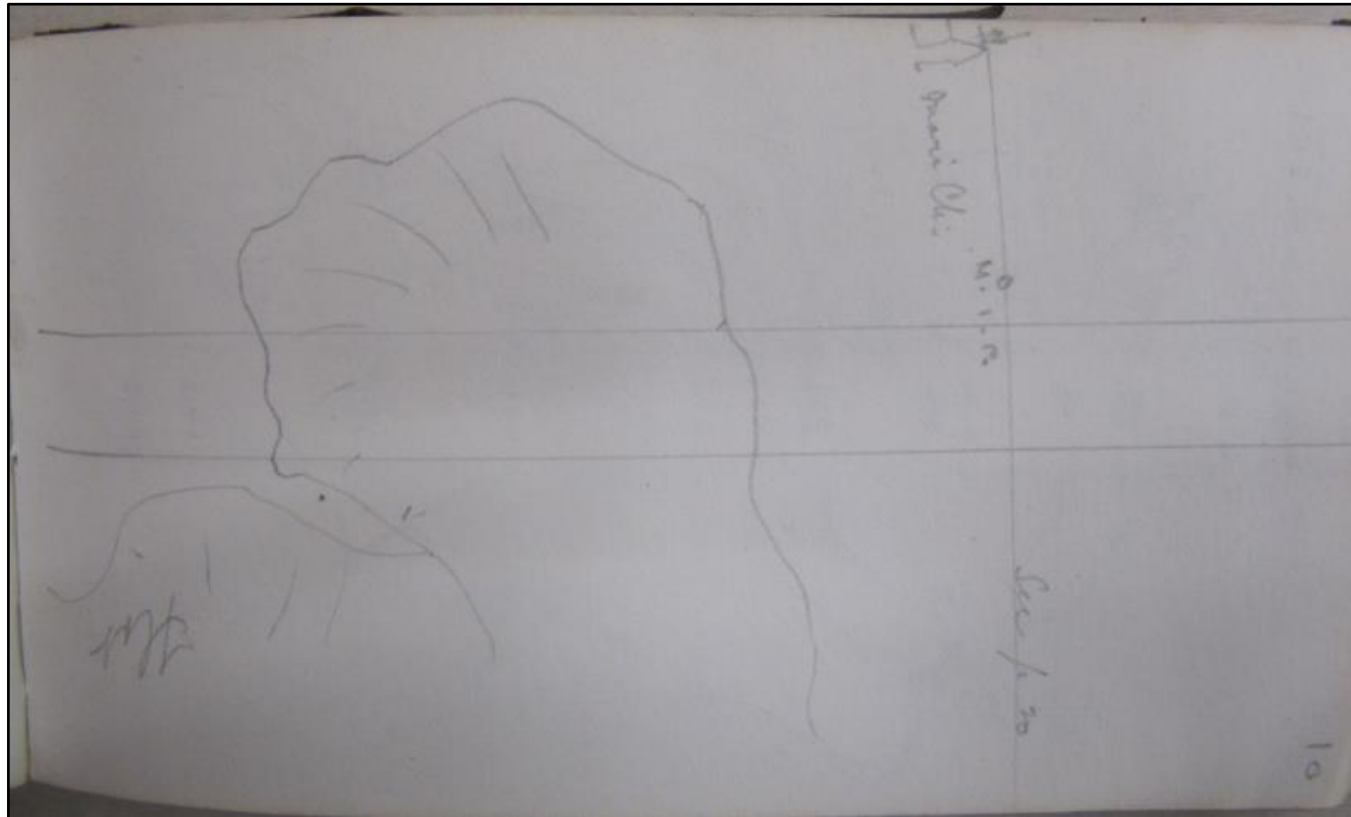

(Reference Archives NZ Wellington R22395531 AATE W3401 box 2 Surveyor Field Books [10 books] Wellington, Hutt, Masterton Railway JH Loh years 1874 - No 8 Silver Stream General Survey of Neighbourhood Railway Diversion Trail Survey Hutt River at Gorge to Smiths Round Hill Sides – J H Lowe Book 8 = images saved IMG_2479.jpg)

Top-west	Section? – Maori Church
Botton-east	Section? - Flat
Comments	The Whirinaki Maori Church existed in 1874

1874 Survey of Upper Hutt district – Wellington to Wairarapa Railway Line

← South – North →

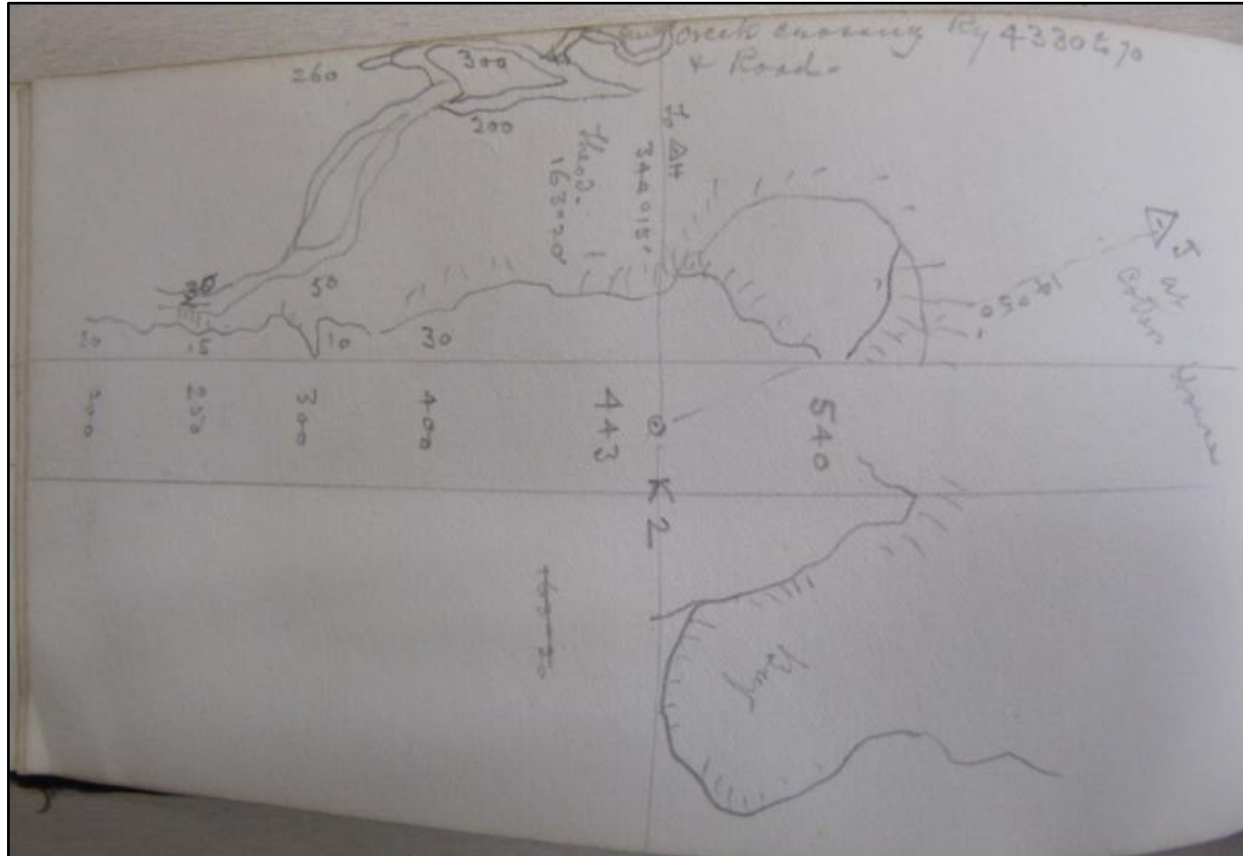

(Reference Archives NZ Wellington R22395531 AATE W3401 box 2 Surveyor Field Books [10 books] Wellington, Hutt, Masterton Railway JH Loh years 1874 - No 8 Silver Stream General Survey of Neighbourhood Railway Diversion Trail Survey Hutt River at Gorge to Smiths Round Hill Sides – J H Lowe Book 8 = images saved IMG_2480.jpg)

Top Section? – Creek crossing Ry (railway) & Road – Cotters house (the survey was taken from the house)
Comments House not drawn on plan just a note stating that the survey measurements was taken from the Cotters house

1874 Survey of Upper Hutt district – Wellington to Wairarapa Railway Line

← - - - →

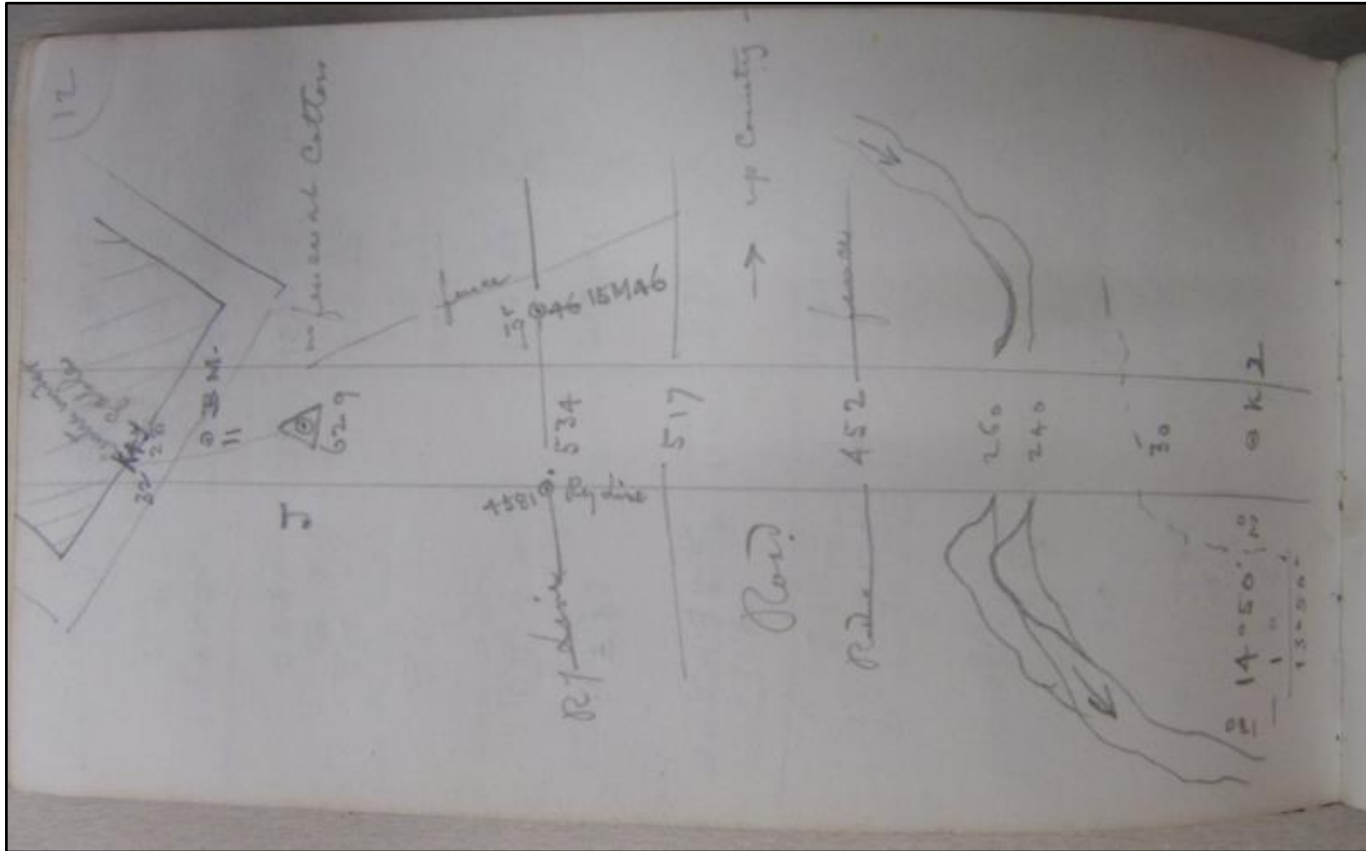

(Reference Archives NZ Wellington R22395531 AATE W3401 box 2 Surveyor Field Books [10 books] Wellington, Hutt, Masterton Railway JH Loh years 1874 - No 8 Silver Stream General Survey of Neighbourhood Railway Diversion Trail Survey Hutt River at Gorge to Smiths Round Hill Sides – J H Lowe Book 8 = images saved IMG_2481.jpg)

Middle Section? – Centre under Gable – in fence at Cotters – Fence line – Road up Country – Road fence
Comments

1874 Survey of Upper Hutt district – Wellington to Wairarapa Railway Line

← South – North →

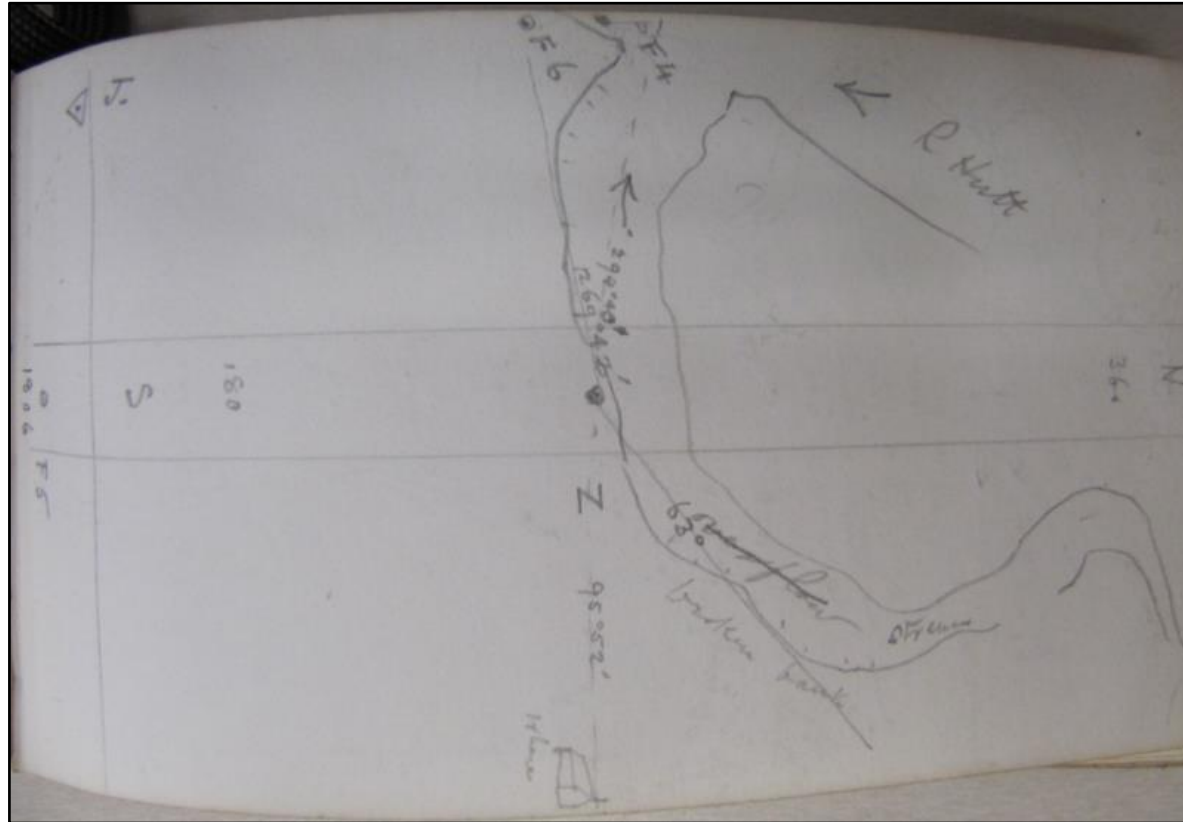

(Reference Archives NZ Wellington R22395531 AATE W3401 box 2 Surveyor Field Books [10 books] Wellington, Hutt, Masterton Railway JH Loh years 1874 - No 8 Silver Stream General Survey of Neighbourhood Railway Diversion Trail Survey Hutt River at Gorge to Smiths Round Hill Sides – J H Lowe Book 8 = images saved IMG_2475.jpg & IMG_2482.jpg)

Top-west Section? – River Hutt
Bottom-east Section? – Whare – Stream – Broken banks
Comments

1874 Survey of Upper Hutt district – Wellington to Wairarapa Railway Line

← South – North →

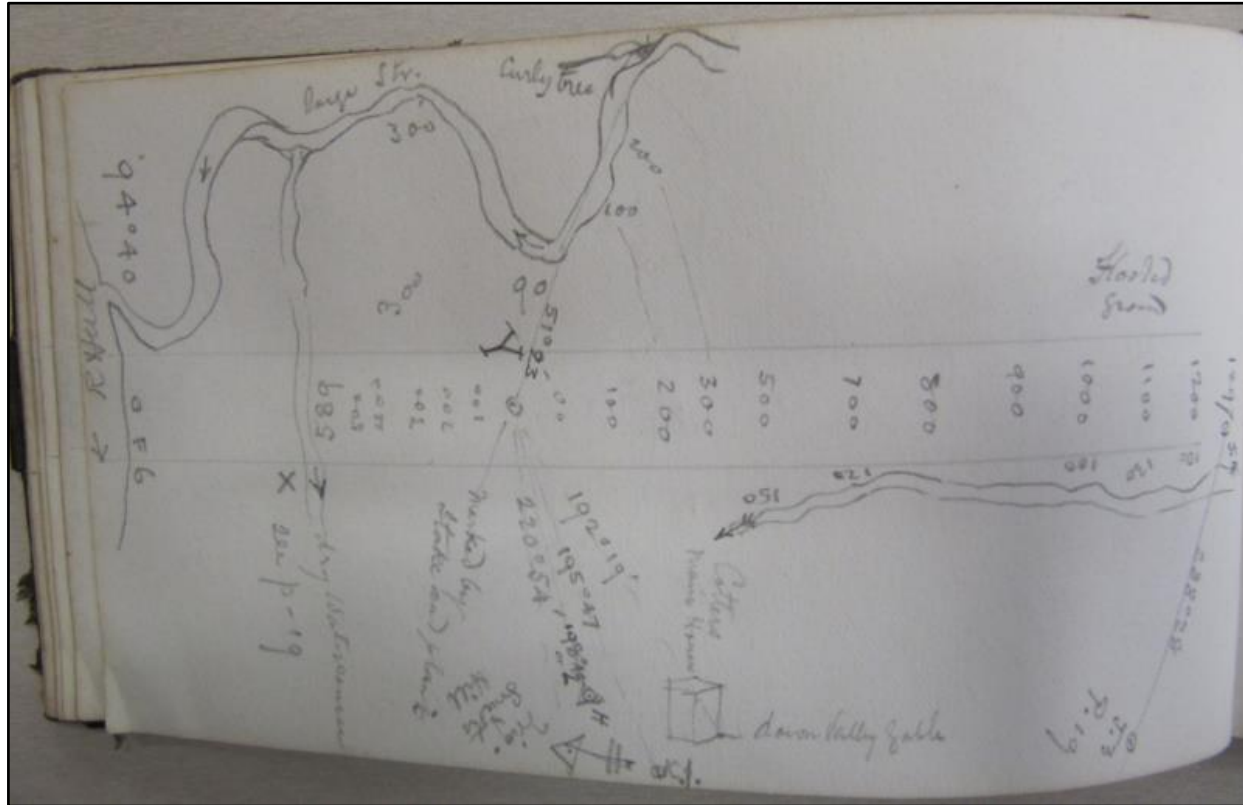

(Reference Archives NZ Wellington R22395531 AATE W3401 box 2 Surveyor Field Books [10 books] Wellington, Hutt, Masterton Railway JH Loh years 1874 - No 8 Silver Stream General Survey of Neighbourhood Railway Diversion Trail Survey Hutt River at Gorge to Smiths Round Hill Sides – J H Lowe Book 8 = images saved IMG_2483.jpg & IMG_2473.jpg)

Top	Section? – R (river) Hutt – Gorge Stream – Curly Tree – Hollow ground
Bottom	Section? - Cotters Main House – Down Valley Gable – Trig Smiths Hill – marked by stake and plant or plank – Dry water creek
Comments	(Survey taken from down valley gable at Cotters House)

1874 Survey of Upper Hutt district – Wellington to Wairarapa Railway Line

← North – South →

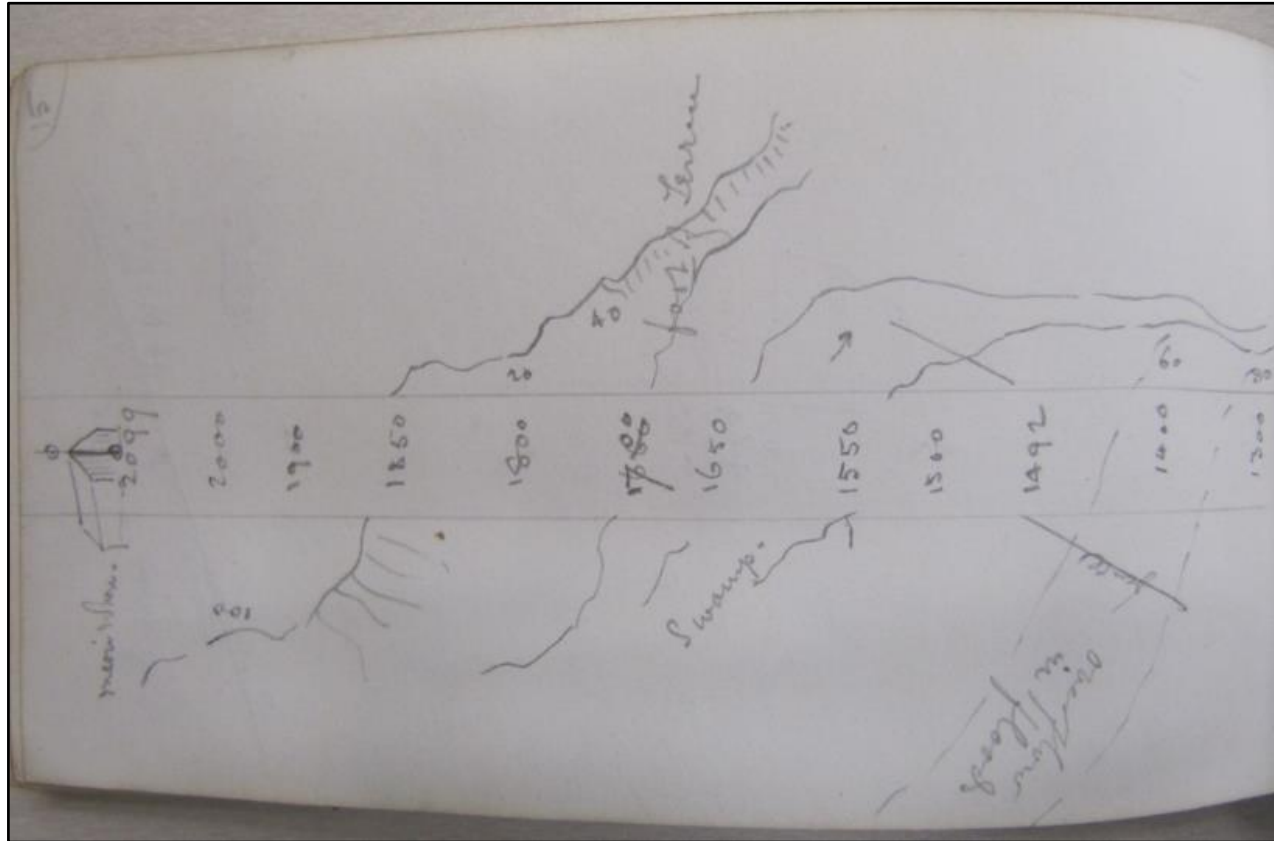

(Reference Archives NZ Wellington R22395531 AATE W3401 box 2 Surveyor Field Books [10 books] Wellington, Hutt, Masterton Railway JH Loh years 1874 - No 8 Silver Stream General Survey of Neighbourhood Railway Diversion Trail Survey Hutt River at Gorge to Smiths Round Hill Sides – J H Lowe Book 8 = images saved IMG_2474.jpg & IMG_2484.jpg)

Middle Section? – Maori Whare – Swamp (west) – Foot of Terrace (east) – Overflow in floods
Comments

1874 Survey of Upper Hutt district – Wellington to Wairarapa Railway Line

← -- →

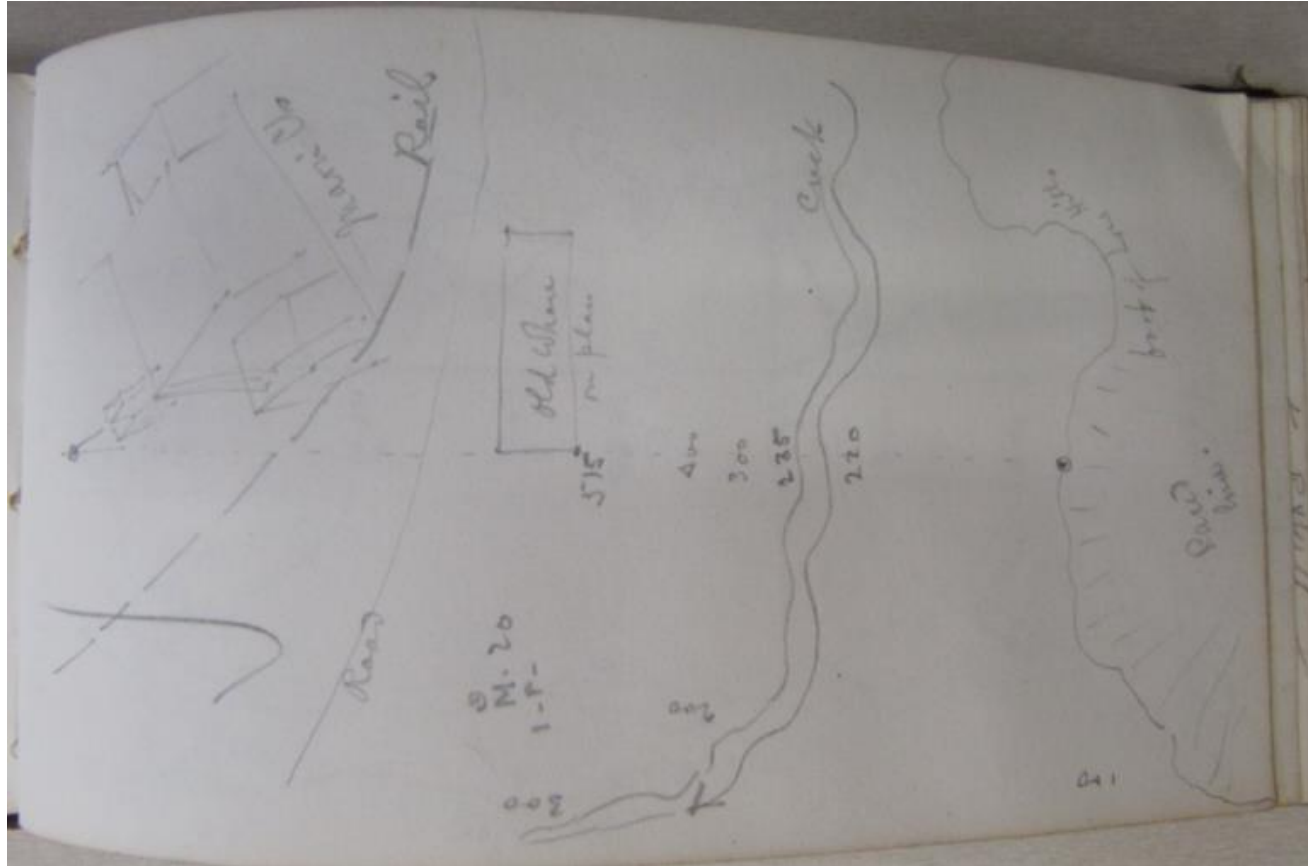

(Reference Archives NZ Wellington R22395531 AATE W3401 box 2 Surveyor Field Books [10 books] Wellington, Hutt, Masterton Railway JH Loh years 1874 - No 8 Silver Stream General Survey of Neighbourhood Railway Diversion Trail Survey Hutt River at Gorge to Smiths Round Hill Sides – J H Lowe Book 8 = images saved IMG_2485.jpg & IMG_2470.jpg)

Comments The Maori Church (Whirinaki) and old Whare are situated in Silverstream but the Road and Railway line are opposite to the final completed railway line. I believe this just an early sketch and we now know the church existed in 1874.

1874 Survey of Upper Hutt district – Wellington to Wairarapa Railway Line

← - - - →

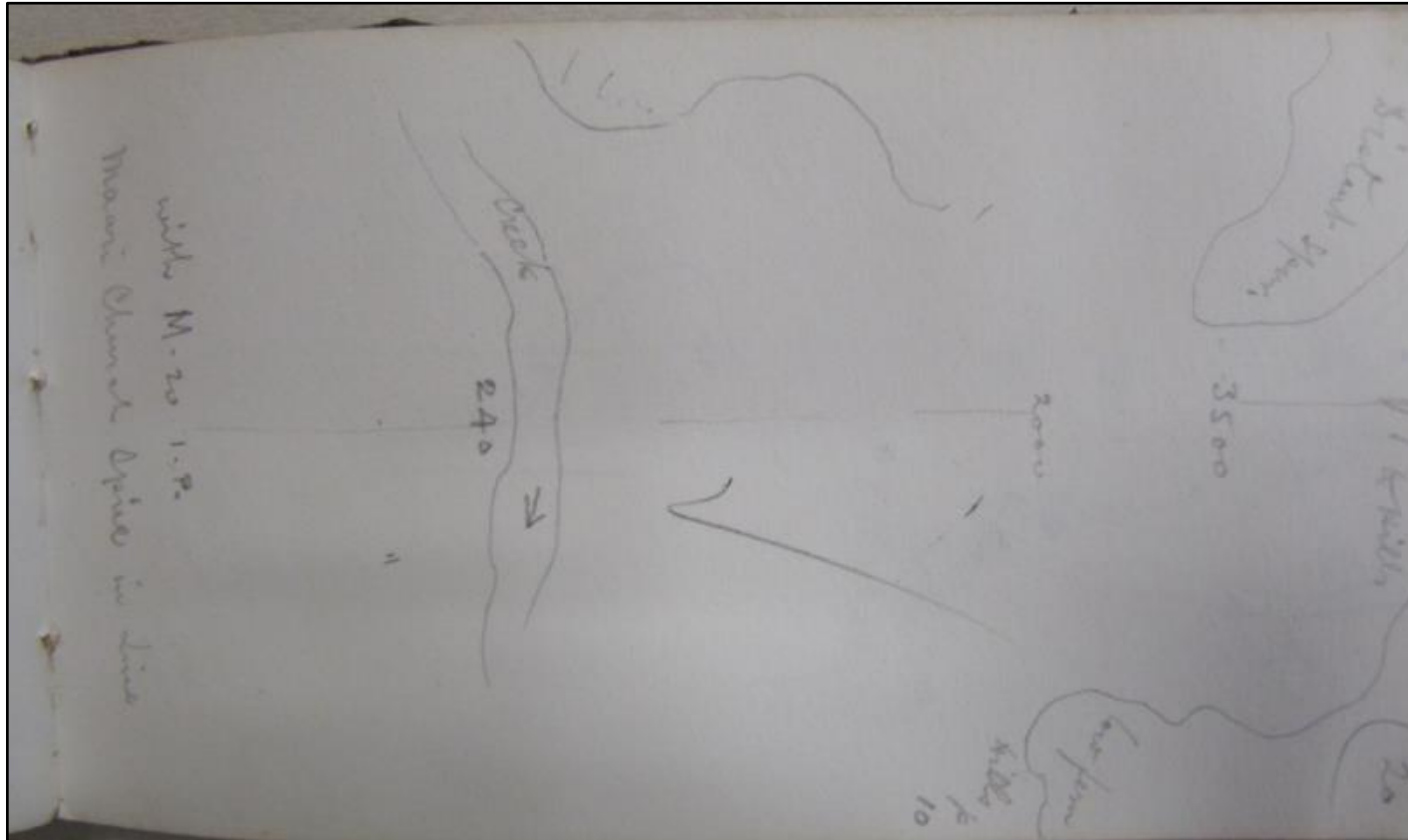

(Reference Archives NZ Wellington R22395531 AATE W3401 box 2 Surveyor Field Books [10 books] Wellington, Hutt, Masterton Railway JH Loh years 1874 - No 8 Silver Stream General Survey of Neighbourhood Railway Diversion Trail Survey Hutt River at Gorge to Smiths Round Hill Sides – J H Lowe Book 8 = images saved IMG_2486.jpg)

Middle Section? – to Hills – Distant Spur – Low fern hills – Creek – Maori Church Spiral in line
Comments Perhaps surveyor took survey from Maori Church Spiral

1874 Survey of Upper Hutt district – Wellington to Wairarapa Railway Line

← South – North →

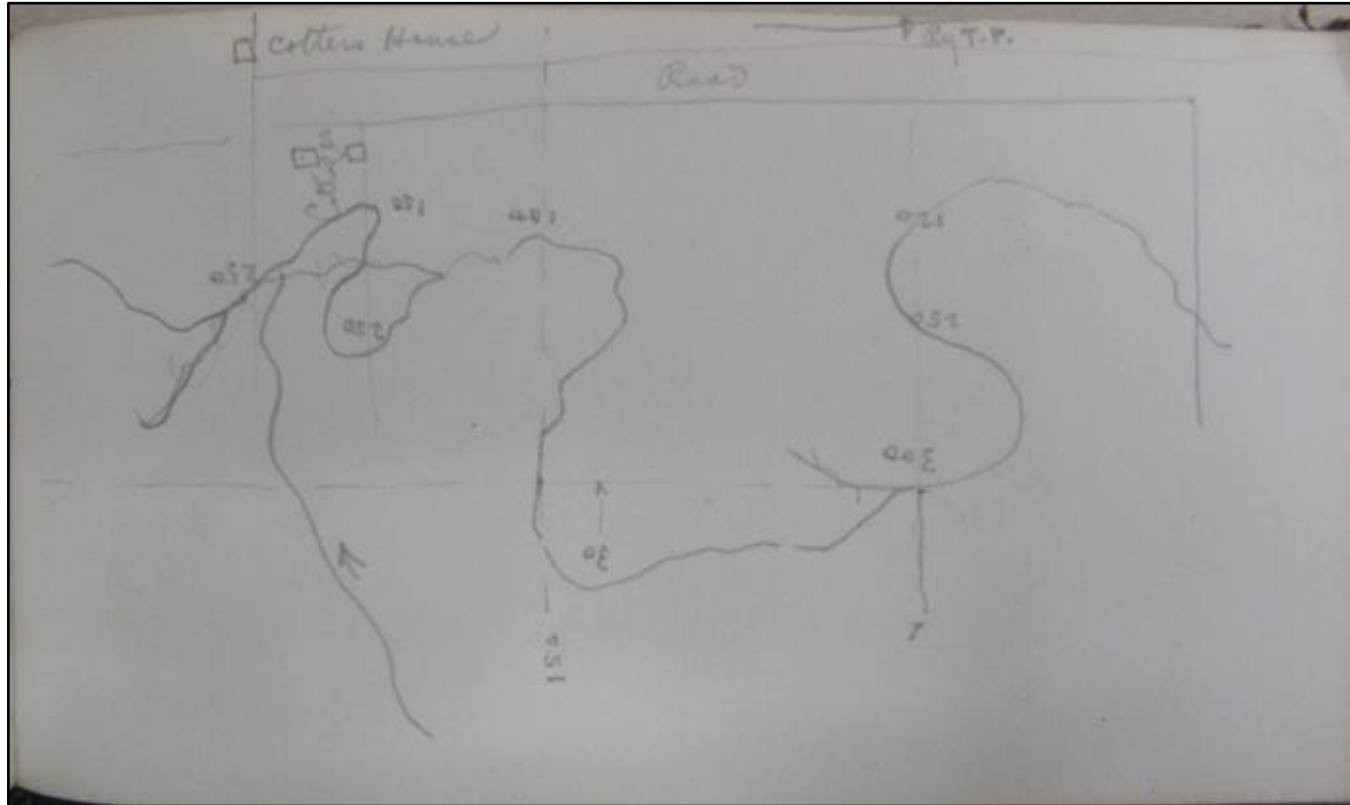

(Reference Archives NZ Wellington R22395531 AATE W3401 box 2 Surveyor Field Books [10 books] Wellington, Hutt, Masterton Railway JH Loh years 1874 - No 8 Silver Stream General Survey of Neighbourhood Railway Diversion Trail Survey Hutt River at Gorge to Smiths Round Hill Sides – J H Lowe Book 8 = images saved IMG_2471.jpg & IMG_2472.jpg & IMG_2488.jpg)

Top-west	Section? – Cotters House - Road
Bottom-east	Section? – Two cottages
Comments	Thomas Cotter Settled in the Silverstream area on land now owned by St Patrick's college.

1874 Survey of Upper Hutt district – Wellington to Wairarapa Railway Line

← - - - →

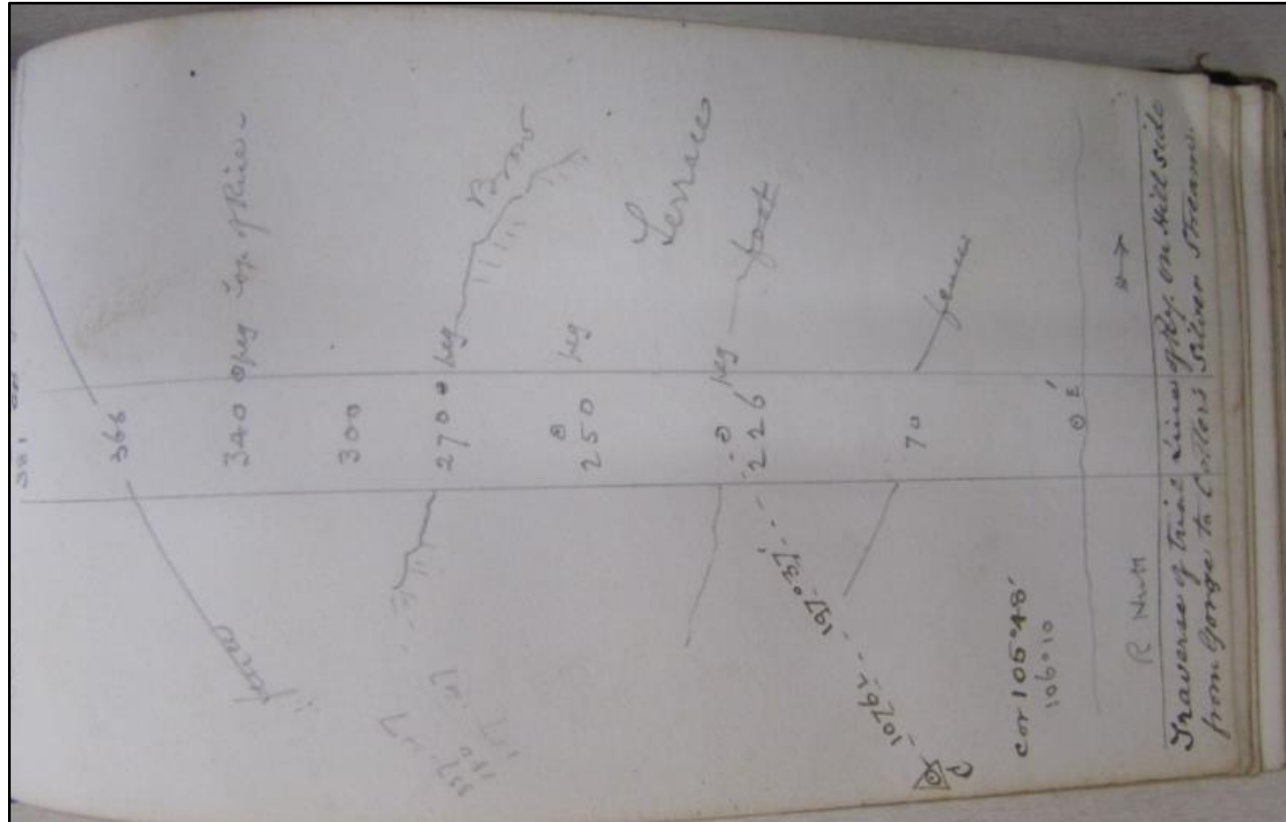

(Reference Archives NZ Wellington R22395531 AATE W3401 box 2 Surveyor Field Books [10 books] Wellington, Hutt, Masterton Railway JH Loh years 1874 - No 8 Silver Stream General Survey of Neighbourhood Railway Diversion Trail Survey Hutt River at Gorge to Smiths Round Hill Sides – J H Lowe Book 8 = images saved IMG_2489.jpg)

Top to bottom Section? – Fence - Peg top of river [sic] – Brow – Terrace – Foot – Fence – River Hutt - Travers of Trail Line of Railway on hillside from Gorge to Cotters Silver Stream

Comments

1874 Survey of Upper Hutt district – Wellington to Wairarapa Railway Line

← - - - →

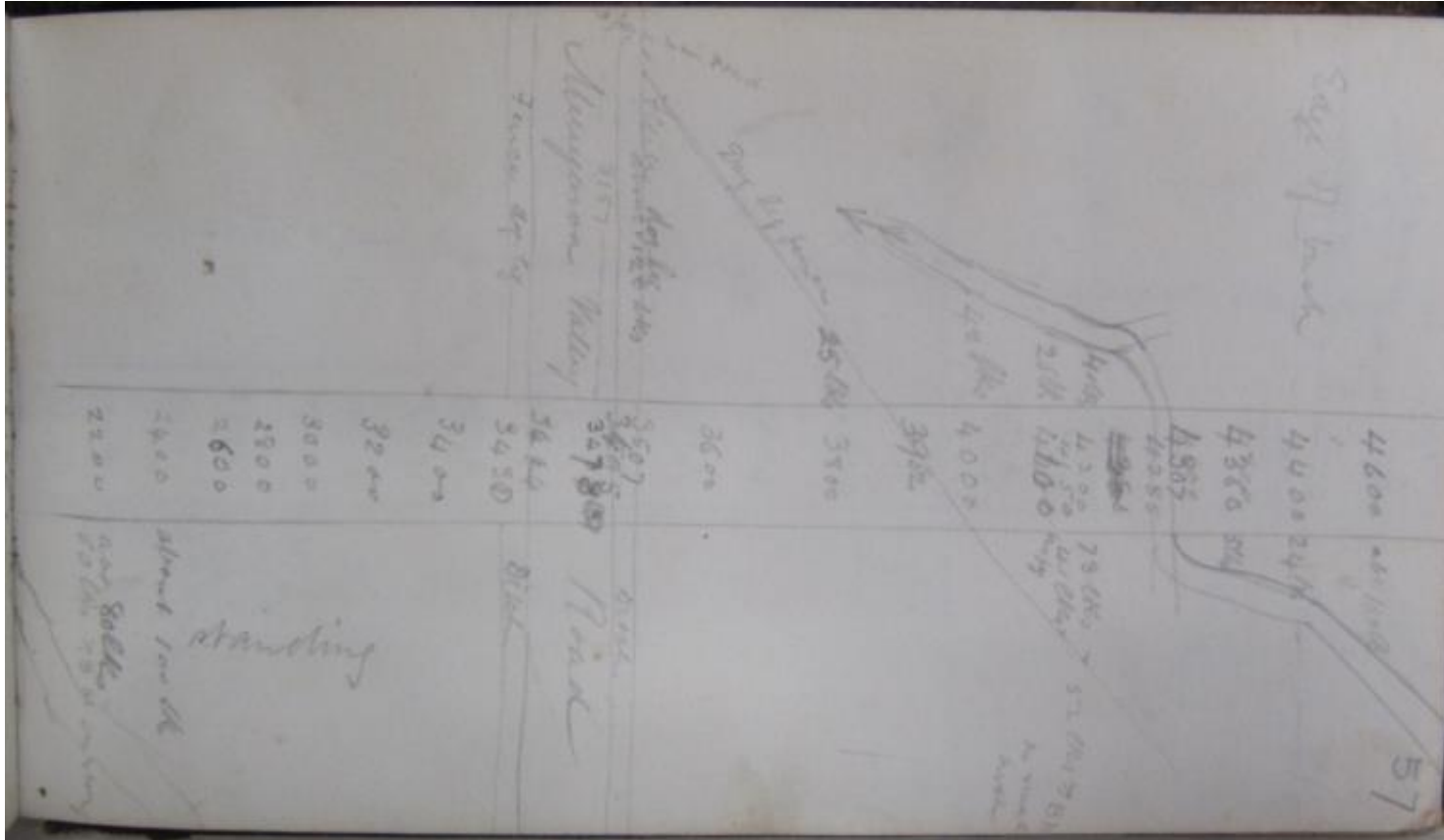

(Reference Archives NZ Wellington R22395531 AATE W3401 box 2 Surveyor Field Books [10 books] Wellington, Hutt, Masterton Railway JH Loh years 1874 - No 8 Silver Stream General Survey of Neighbourhood Railway Diversion Trail Survey Hutt River at Gorge to Smiths Round Hill Sides – J H Lowe Book 8 = images saved IMG_2490.jpg)

Middle Section? – Edge of Bush – Dog [sic] by fence – Mungaroa Valley Road – Fence – Ditch
 Comments Mungaroa Valley Road is now known as Ward Street

1874 Survey of Upper Hutt district – Wellington to Wairarapa Railway Line

← -- →

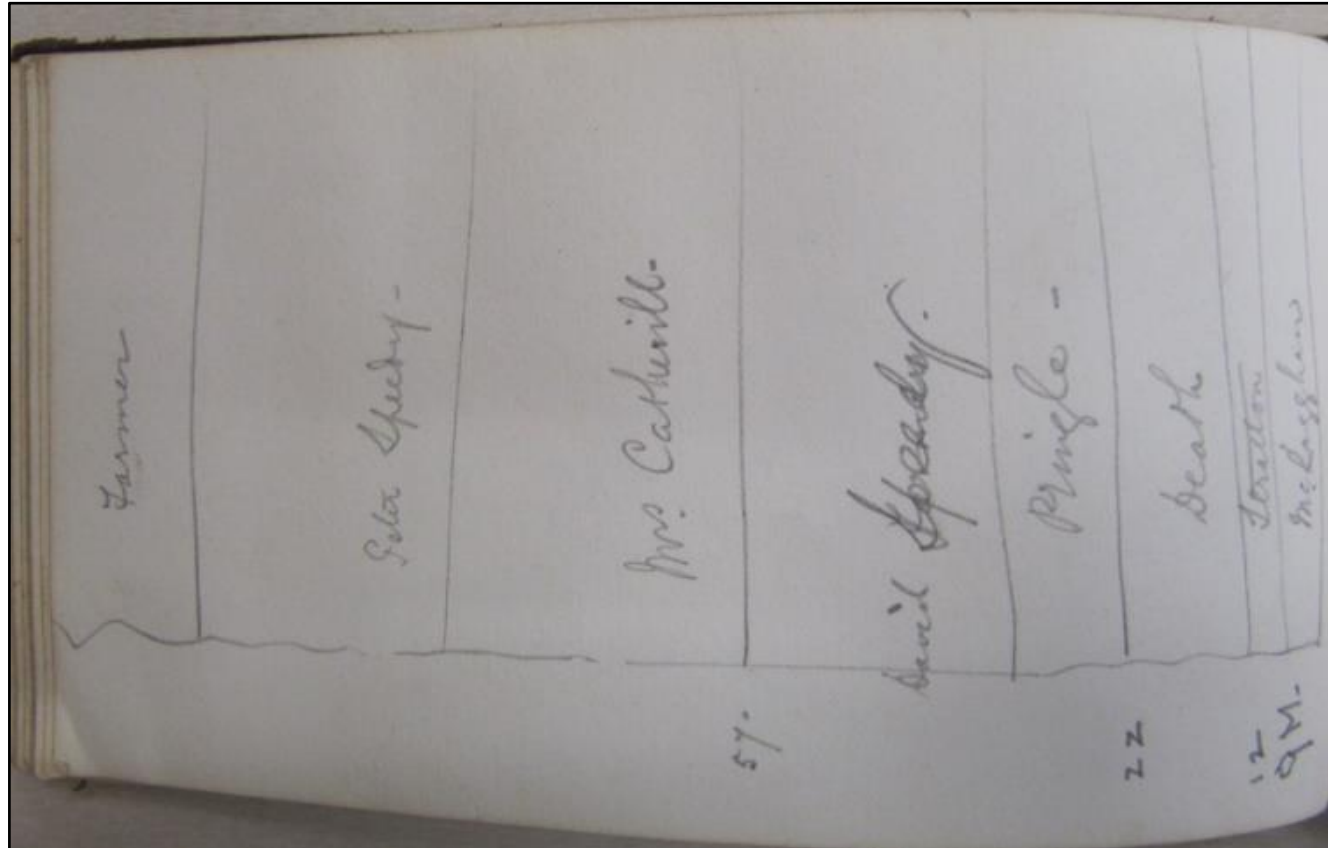

(Reference Archives NZ Wellington R22395531 AATE W3401 box 2 Surveyor Field Books [10 books] Wellington, Hutt, Masterton Railway JH Loh years 1874 - No 8 Silver Stream General Survey of Neighbourhood Railway Diversion Trail Survey Hutt River at Gorge to Smiths Round Hill Sides – J H Lowe Book 8 = images saved IMG_2491.jpg)

Top to bottom Section? – Farmer – Peter Speedy – Mrs Catherill – David Speedy – Pringle – Death - Stratton - McLagham
Comments I do not know if these people are the occupiers of land in the Upper Hutt district

1874 Survey of Upper Hutt district – Wellington to Wairarapa Railway Line

← -- →

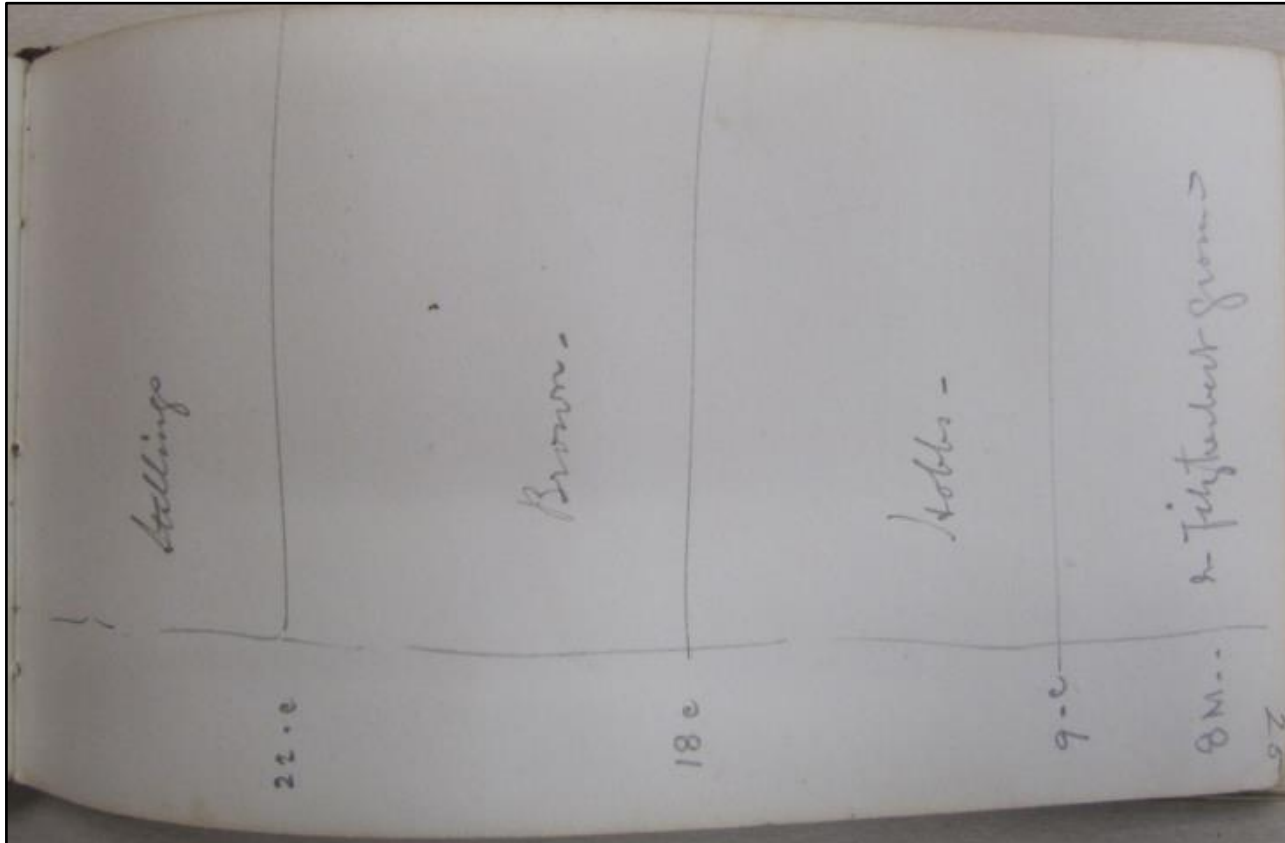

(Reference Archives NZ Wellington R22395531 AATE W3401 box 2 Surveyor Field Books [10 books] Wellington, Hutt, Masterton Railway JH Loh years 1874 - No 8 Silver Stream General Survey of Neighbourhood Railway Diversion Trail Survey Hutt River at Gorge to Smiths Round Hill Sides – J H Lowe Book 8 = images saved IMG_2492.jpg)

Top to bottom Section? – Stillings – Brown – Hobbs – Mr Fitzgerald ground
Comments I do not know if these people are the occupiers of land in the Upper Hutt district

1874 Survey of Upper Hutt district – Wellington to Wairarapa Railway Line

← -- →

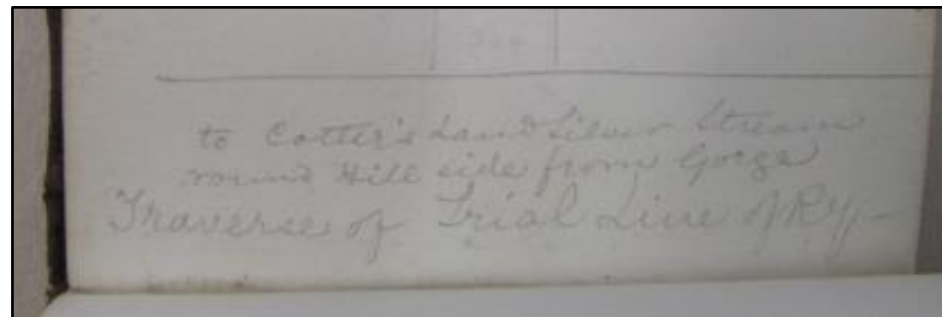
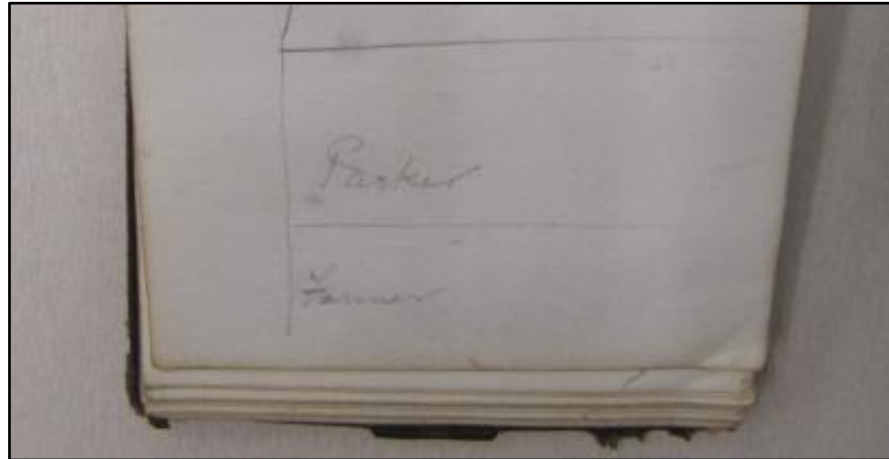

(Reference Archives NZ Wellington R22395531 AATE W3401 box 2 Surveyor Field Books [10 books] Wellington, Hutt, Masterton Railway JH Loh years 1874 - No 8 Silver Stream General Survey of Neighbourhood Railway Diversion Trail Survey Hutt River at Gorge to Smiths Round Hill Sides – J H Lowe Book 8 = images saved IMG_2493.jpg & IMG_2494.jpg)

Top-image	Section? – Parker – Farmer
Bottom-image	Section? – To Cotter's Land Silver Stream round hillside from Gorge – Traverse of Trail Line of Railway
Comments	I do not know if these people are the occupiers of land in the Upper Hutt district