

SECTION 97 Silverstream

Owners & Settlers = 1840s/1850s George LACHLAN (absentee land owner) – 1858 David SMITH – 1858 William SMITH – 1863 & 1870 John MCKENZIE – 1870 William FRANCIS – 1876 NZ Railways – 1910 William George GARD

Buildings = Post Office, Silverstream Railway, Silverstream School – St Mary's Church -
Subdivisions & Settlers = 1910 Township of Silverstream – Chatsworth Road, Gloucester Road, Marlborough Road, Pemysey Road & 1921 Terminus Road & 1939 Birch-Tree Estate - Heretaunga Square, Pemysey Street, Coates Street, Hood Street, Elizabeth Street, York Avenue, Aorangi Street

Search Quick Maps = DP 10057 & A 2683

1840-1850

1843 Survey Map New Zealand Company

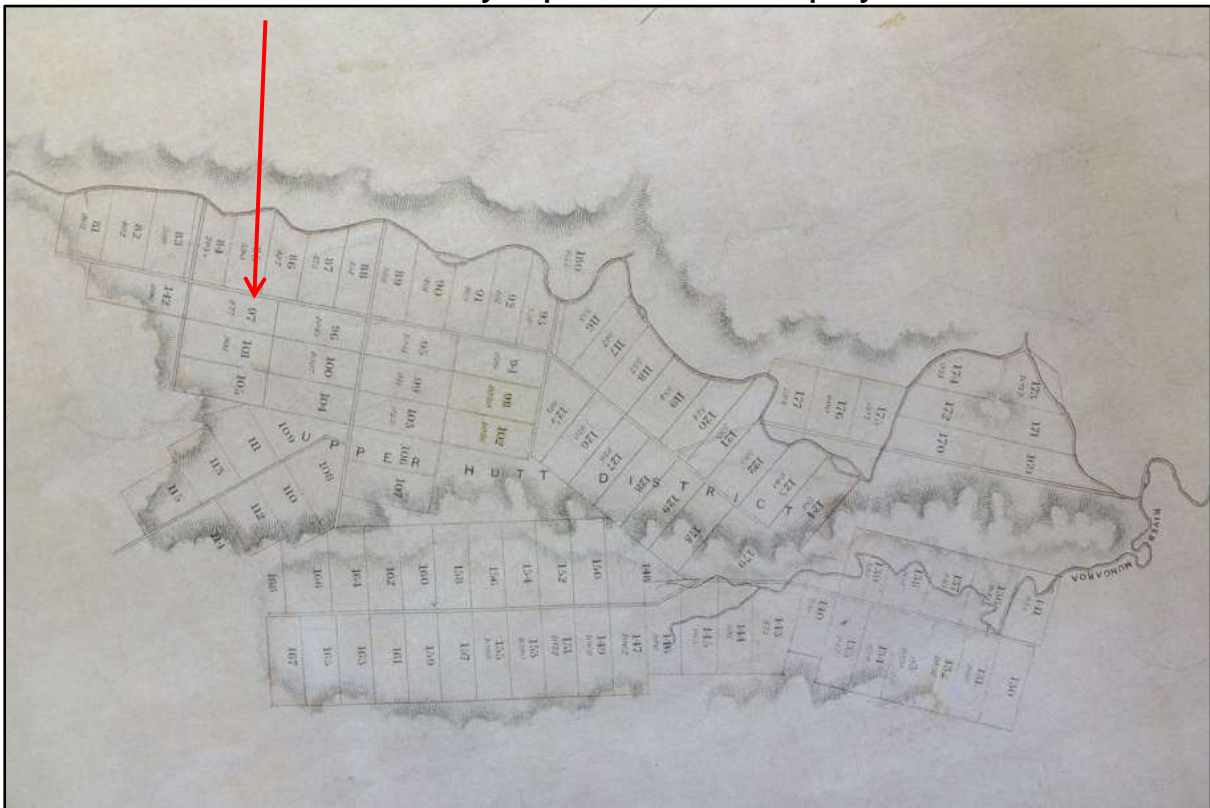

(Reference New Zealand Defence Force Map Library 1843 New Zealand Company Survey Map)

No 97 Hutt Valley (Upper)

- This Section was selected by Robert PARKS for George LACHLAN senior the original owner of Preliminary Land Order No 877
- A Supplementary Land Order for 75 acres issued in England to George LACHAN for this Land order
- Claimant by George LACHAN Claim No 655 Report No 544 Grant No 1056 issued to George LACHAN dated 09th August 1856 (signed) Thomas Gore BROWNE

(Source Archives New Zealand Wellington reference ADXS 19555 LS-W65 3 43 register of Hutt Valley selections and also outwards letters October 1848 to November 1850)

1850-1860

1850s absentee owner of Section No 97 George LACHAN or LACHLAN

July 1851

No on plan of District [Section] 97 – By whom chosen R PARK - No of Land Order chosen under 877 – Original Purchaser George LACHLAN junior – Transfers A Suppl. Land Order for 75 acres issued in England to George Lachlan for this Land Order – Present Owners as per Company Books George LACHLAN

(written in red pencil Claimant George Lachlan Claim 655 Report 544 Grant 1056)

(Reference Archives New Zealand Wellington R17533447 ADXS 19556 LS-W65 1 21 register of sections country districts Upper Hutt)

1858 owner or occupier of Section No 97 David SMITH and/or William SMITH

Section 97 = Deeds Index Map C Hutt District No 97 page 104 (Image 54) [Appln.4984, 4286]

No - Receipt of Instrument – Nature of Instruction – Parties – Date of Instrument – Where recorded – Reference – Signature

- 1154 – ½p2 13 September 1858 – Conveyance – Lachlan at the request of D Smith to W Smith – 10 February 1857 – 3 D56 – 3/643
- 3566 - ½p2 16 February 1863 – Conveyance – Lachlan to McKenzie – 03 September 1862 - * D250 – 6/248
- 26934 – 2pm 25 April 1877 – Crown Grant – George Lachlan – 09 August 1856 – 5 G122 – NR – D742
- 23907 – 10.30 01 May 1876 – Memorial of Proclamation – Government of NZ – 07 April 1876 – Reg. by deposit

Closed C6218

(Reference Archives NZ Wellington website = Deeds Index AFH series 22394 W569 1/43 vol 3/1 page 104 scanned image 54)

Section No 97 Hutt Valley (Upper)

- Claimant by George LACHAN Claim No 655 Report No 544 Grant No 1056 issued to George LACHAN dated 09th August 1856 (signed) Thomas Gore BROWNE

(Source Archives New Zealand Wellington reference ADXS 19555 LS-W65 3 43 register of Hutt Valley selections and also outwards letters October 1848 to November 1850)

Section 97 - Wellington Land Claims

Claim George LACHLAN London (655) Crown Grant ALSO Country section 97 Upper Hutt district date 30 October 1852 No 544 Claim 655

(Reference Archives New Zealand Wellington reference LS-W W68 1 1-100 Wellington Land Claims Commissioners Reports 1-100 - October 1851 – April 1852)

1860-1870

1860s Map of Silverstream – Section No 97



(Reference UH Map 1860s Silverstream JGillard WNC_SO_10985_I-1.jpg)

1870-1880

1870 Owner or occupier of Section No 97 John MCKENZIE and/or William FRANCIS

Wellington Independent newspaper 25 October 1870

Fencing Notice – To John McKenzie or the owner of part Section No 97 on the plan of the Upper Hutt. I hereby give you notice to erect half of the fence dividing your portion of No 97. If not put up within fourteen days from the date hereof I shall proceed to erect the same at your expense in accordance with the Fencing Act – William Francis – 25 October 1870

(Reference Papers past website Wellington Independent newspaper 25 & 27 October 1870)

1874 Survey for Railway Line (Whirinaki Silverstream)

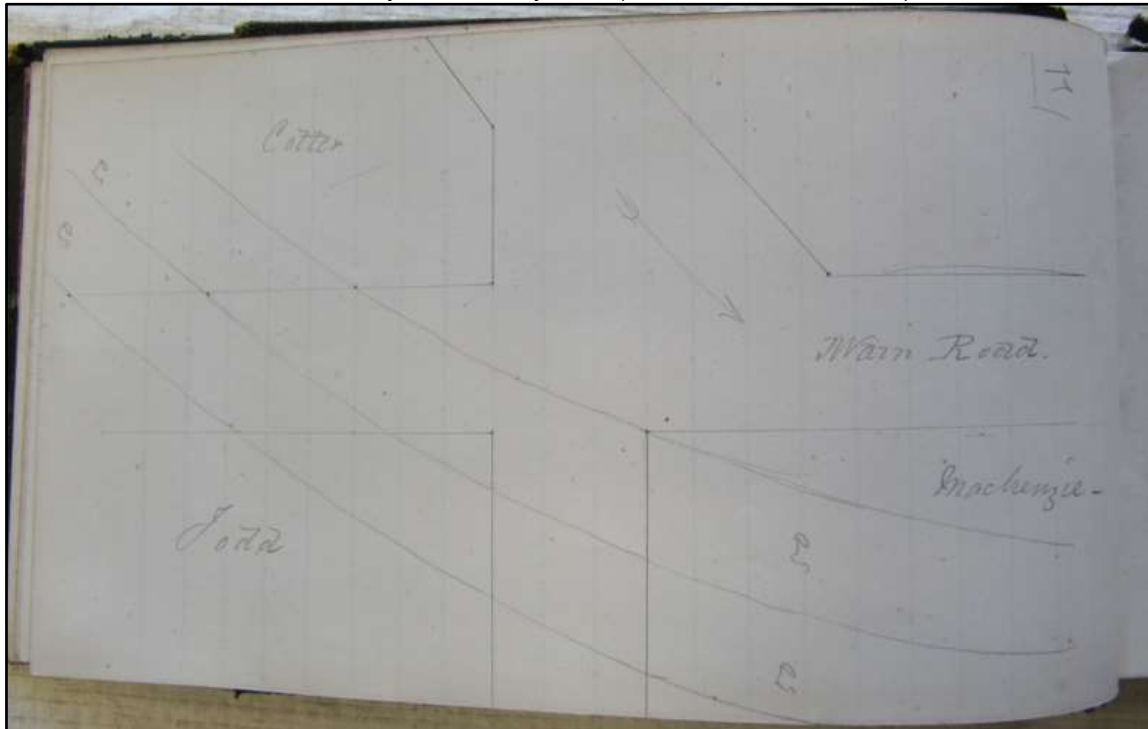

(Reference Archives NZ Wellington UH Railway 1874 Survey Book Mungaroa IMG_2552.JPG)

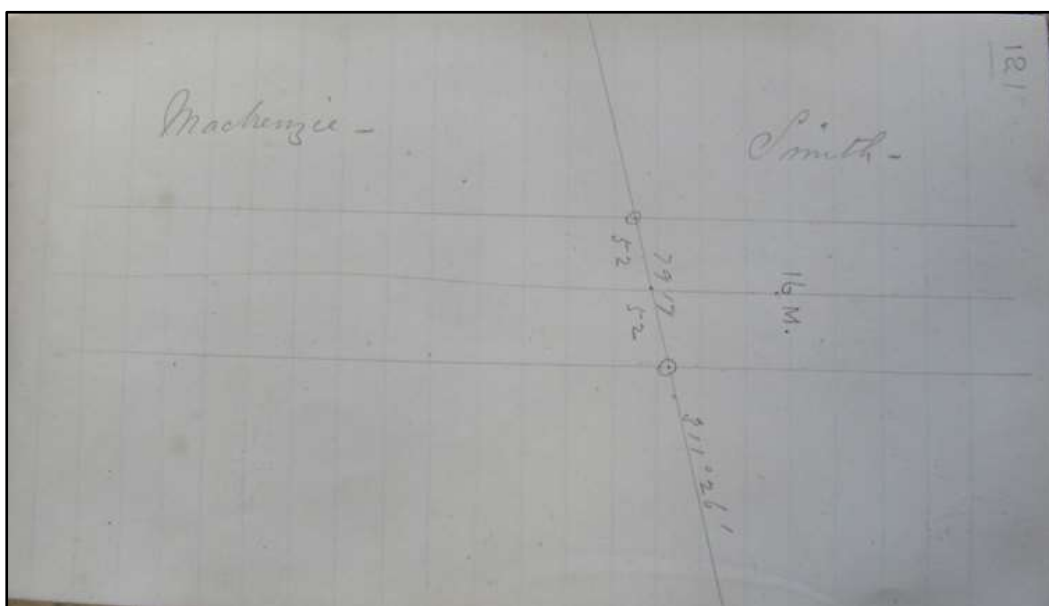

(Reference Archives NZ Wellington UH Railway 1874 Survey Book Mungaroa IMG_2551.JPG)

1876 owner of part Section No 97 Government for New Zealand Railways

Section 97 = Deeds Index Map C Hutt District No 97 page 104 (Image 54) [Appln.4984, 4286]

- 23907 – 10.30 01 May 1876 – Memorial of Proclamation – Government of NZ – 07 April 1876
– Reg. by deposit

Closed C6218

(Reference Archives NZ Wellington website = Deeds Index AFH series 22394 W569 1/43 vol 3/1 page 104 scanned image 54)

SEARCH THE 1870S SURVEY MAP AND/OR SURVEYORS DIARIES AS THEY MAY HOLD FURTHER INFORMATION ON SECTION NO 97 IN SILVERSTREAM

1890-1900

Section 97 part of Township of Silverstream



1900-1910

1907 Silverstream Chatsworth Estate subdivision on part Section No 97

SILVERSTREAM, THE SYLVAN RETREAT
OF THE HUTT VALLEY.
CHARMING SITES for WEEK-END BUNGALOWS or PERMANENT RESIDENCES.

Situated between the Railway Station and the Golf Links.
SERVED BY 16 TRAINS DAILY.

CHATSWORTH ESTATE
To be Sold at PUBLIC AUCTION
By GEN. THOMAS & CO., in conjunction with MCKEE & CO., Ltd.
Chamber of Commerce, National Mutual Buildings
On WEDNESDAY, the 27th February, at 8 p.m.

McKee & Co., Ltd., 1, Panama St., Wellington.

The advertisement includes a plan of the Chatsworth Estate subdivisions, showing several rectangular plots. A smaller inset plan shows the location of the estate relative to the railway line and other local features.

(Reference UH Estate 1907 Chatsworth LHCC255_Arch_72728.jpg)

Enlarged bottom right portion of above subdivision plan

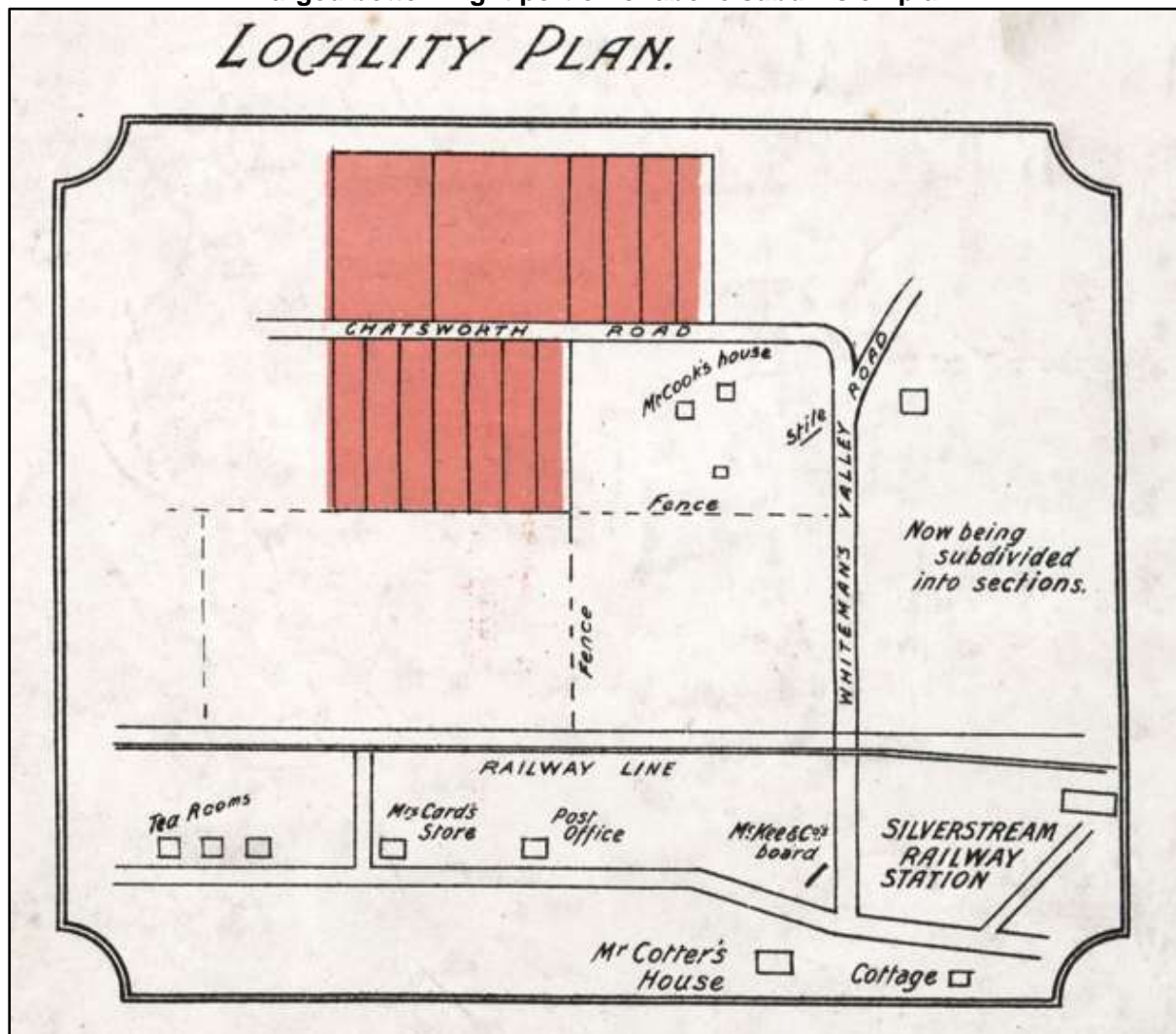

(Reference UH Estate 1907 Chatsworth LHCC255_Arch_72728.jpg)

1910 Owner or occupier of Section No 97 William George GARD

1909 Section No 97 DP 2332



1909 Chelsea Subdivision
(William George Gard was born in Chelsea England)

CHELSEA SILVERSTREAM ESTATE

Fine Sites for Permanent Homes
For Sale by Auction by
Messrs. J. H. BETHUNE & Co.
at their Rooms, Featherston Street, Wellington,
on
Monday, 15th February, 1909,
at 8 p.m.

CHELSEA ESTATE is within easy reach of the City and is included in the Suburban area.

18 TRAINS DAILY.

Fishing, Golfing, Shooting and Racing within a few minutes walk. The Land is dry, healthy and **ABSOLUTELY FREE FROM FLOODS.** The Post and Telephone Offices, Store, etc. are close to Chelsea Estate.

The Land for Sale is situated on the East side of the Railway line. It is sufficiently elevated to command a panoramic view of the beautiful Hutt Valley and the Golf Links, whilst it escapes altogether the dust of the Main Road.

Silverstream is the Sports Ground of Wellington, and Chelsea Estate is the most central Subdivision open for public sale. Some of the finest Residences in the Dominion have recently been erected in the locality, whilst contracts have been let for the erection of many others during the summer.

THE TERMS OF SALE are exceptionally liberal:

10 per cent. Cash Deposit.	10 per cent. in 9 months.
10 per cent. in 6 months.	10 per cent. in 12 months.

The Balance in three years. Interest at 5 per cent. per annum.

For further particulars apply to **J. H. BETHUNE & CO., Auctioneers,** or Messrs. Izard and Weston, Solicitors, Featherston Street, Wellington.

NOTE DATE OF SALE
Monday, 15th February, 1909,
at 8 p.m.

(Reference Upper Hutt City Library Heritage collection Chelsea Estate P6-37-2096)

1910-1920

1915 Map of Manoeuvre Area Neighbourhood of Trentham Camp



(Reference 1915 Map of Manoeuvre Area Neighbourhood of Trentham Camp UH Map 1915 IMG_4590)

1916 Section No 97 DP 1957

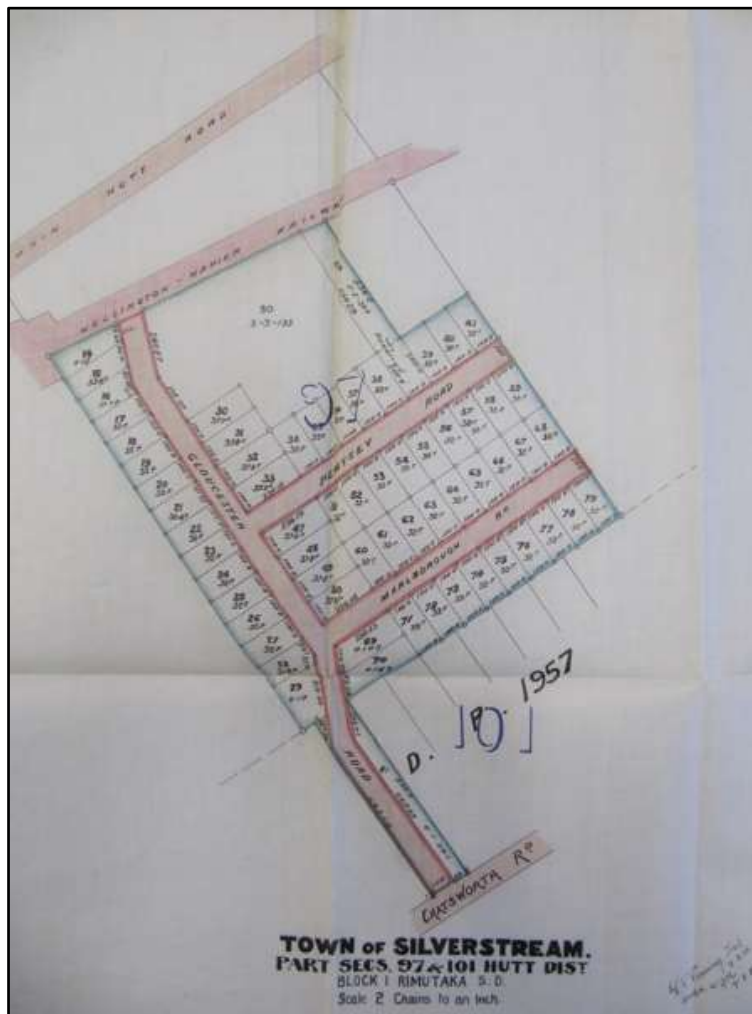

(Reference UH Section 97&101 Silverstream 1916 saves as IMG_4433.JPG)

1919 Map – Section No 97

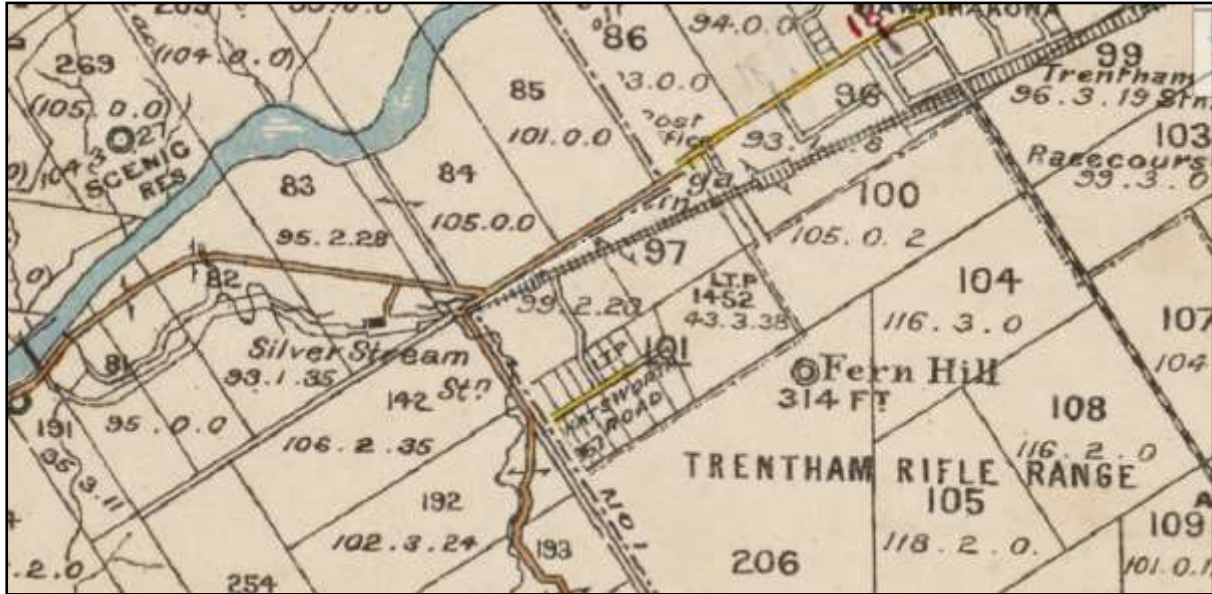

(Reference Maps past 1919 Silverstream Upper Hutt)

1910 Township of Silverstream section 97 & 101 Hutt & part section 142 Belmont

- PLAN Town of Silverstream part **Sections 97 & 101** Hutt District Block 1 Rimutaka SD Main Hutt Road, Wellington Napier Railway Gloucester Road, Pemysey Road, Marlborough Road & Chatsworth Road DP 1957 signed G V Venming 9.3.10 & WJA 9.3.10 = saved 30/08/2017 as IMG_4433.JPG
- PLAN Locality plan Part Block 1 Rimutaka SD – Rimutaka SD Block 1 & Belmont block IV SD - **Sections 83, 84, 85, 86, 96, 97, 100, 101, 142, 192, 193** = saved 30/08/2017 as IMG_
- 24 February 1910 from Chief Surveyor to Surveyor General – Town of Silverstream I have the honour to forward the plan of above Town for the approval if the Governor in terms of section 16 of “The Land Act 1908”. Chatsworth Road is public and is 66 feet wide. Pemysey Pemysey, Marlborough and Gloucester Roads are now new and are 66 feet wide. The lots with the exception of 14, 15, 16, 29, 69 and 70 are laid off at right angles to the roads and all the lots are of good proportion. Please not Lot 80 contains s3.3r.13.3p which area is in excess of that allowed by the Regulation but the inclusion of that lot adds to the compactness of the scheme. The name of the Town is I think appropriate as it lies close to the Stream and Railway Station of that name. See accompanying tracing of locality. Under the circumstances enumerated above I have to recommend the plan be submitted to the Governor for his approval as required by the above mentions section of the Land Act.
- 30 March 1910 from Surveyor General to Chief Surveyor Town of Silverstream referring to memo re 1 link west of Gloucester Road form part of subdivision No 29 – scheme and name appear suitable otherwise
- 05 April 1910 from Chief Surveyor to Surveyor General Town of Silverstream The Surveyor was interviewed with regard to the link Reserve along part of Gloucester Road and he states it was laid off in accordance with instructions. It is evidently the intention of the owner of the land being subdivided to stop be means of the link strip the owner bounding it on the south-west from in the future subdividing upon a street the expense of the formation of which was wholly born by the owner of the present subdivision
- 07 April 1910 from Surveyor General to Chief Surveyor Town of Silverstream acknowledge link reserve along par f Gloucester Road in the above Township inform you that I am not prepared to pass the plan with this link strip. It seems hard on but in the public interest I am of the opinion that it must be done in this case (partial transcription of letter)
- 12 Panama Street from Frank E Willis to Chief Surveyor Plan of Town of Silverstream Mr Hanify Surveyor has handed me your communication of the 18th April and I have interviewed Mr Gard the owner of the property comprised in the plan from which the Surveyor General has withheld the Governor’s approval. I wish to state that Mr Client Mr Gard has made several unsuccessful attempts to obtain from the adjoining owner of the link strip a

contribution towards the cost of formation of that portion of Gloucester Road abutting the strip. He first approached this adjoining owner before the subdivision was actually made and has since done so after being notified of the refusal to approve but can come to no arrangement with his neighbour. Before making this subdivision by client was obliged to purchase the allotment of which this strip forms part in order to comply with the condition which require that a new subdivision must be connected with an existing road or Street my client having only a Railway Crossing to connect with the main road therefore could not subdivide his land without buying a piece of land to give him access to Chatsworth Road. By refusing to approve this plan In its present from my client will suffer great hardship and in justice as he will have to bear the total cost of forming and dedicating a road which is the street is deleted can immediately on dedication be used by the adjoining owner for subdivision purposes although such adjoining owner has had every opportunity of taking advantage of this road on payment of a small sum of money towards the costs of formation. I therefore on behalf of Mr Gard request that the Governor's approval be no longer withheld and am instructed that as the question of public interest is not involved at all to insist on the plan being approved otherwise my instructions are to proceed further with the matter. I return the plan herewith.

- 24 May 1910 from Chief Surveyor to Surveyor General Town of Silverstream memo
- 31 May 1910 from Surveyor General to Chief Surveyor Town of Silverstream I have to acknowledge the receipt of your memorandum of the 24th instant referring to the above Town and enclosing copy of a letter received by you from Mr Wills Solicitor on behalf of Mr Gard. After due consideration of the matter I have to inform you that in view of the repeated efforts made by Mr Gard to some to terms with his neighbour who it appears is probably desirous of obtaining the advantage of Mr Gard's road dedication and construction for nothing and also on account of the road not shutting off any existing or proposed road I think that probably the question of public policy is doubtful in this case and I therefore agree to the plan now going on for the Governor's signature. Had the reserve of one link been across the end of an existing or even of a surveyed road I should not have agreed
- 31 May 1910 from Surveyor General to Minister of Lands Town of Silverstream Wellington Land District I have the honour to recommend that you exercise the power conferred upon you by Section 15 of "The Land Act 1908" and authorised the laying-off of Gloucester Road, Pemysey Road and Marlborough Road in the above Town of a width not less than 66 feet (partial transcription of letter) (2 copies of letter)
- 13 June 1910 Wellington His Excellency the Administer of the Government is respectfully advised to sign as approval the accompanying plan of Silverstream Town in terms of Section 16 of "The Land Act 1908 signed Minister of Lands
- 11 June 1910 Authorising the laying off of GLOUCESTER, PEMYSEY and MARLBOROUGH Roads in the Town of Silverstream of a width of not less than 66 feet each Department of Lands Wellington In Pursuance of the power and authority conferred upon me by Section 15 of "The Land Act 1908" I Joseph George Ward Minister of Lands do hereby authorise the laying off of GLOUCESTER, PEMYSEY and MARLBOROUGH Roads in the Town of SILVERSTREAM Wellington Land District of a width of not less than 66 feet instead of 99 feet sign Minister of Lands (NZ Gazette No 59 page 1754 16th June 1910)
- 14 June 1910 from Surveyor General to Chief Surveyor Town of Silverstream returning plan approved by the Governor
- PLAN Town of Silverstream Extension No 1 Plan of Subdivision of part **Section 142** Hutt District Block IV Belmont SD (2 Public Road but no names recorded) H P Hanify Surveyor 27/11/1916 Chief Surveyor H D McKellar approved Minister of Lands 6/3/17 Called as to portion coloured red Minister of Lands 19/12/24 saved 30/08/2017 as IMG_
- 14 February 1917 from Chief Surveyor to Secretary of Lands Town of Silverstream Extension No 1 I beg to forward herewith plan of proposed Town of Silverstream Extension No 1 duly approved for the signature of the Acting Minister of Lands. The sections conform to regulations and front existing public roads. The two strips of 100 links frontage excluded from the proposed town are still parts of section 142 the northern one being the owners present access and the southern one is retained for purpose of future subdivision.
- 02nd 05th March 1917 from Surveyor General Town of Silverstream Extension No 1 requesting approval

- PLAN of Silverstream Extension No 2 being part of **Section 97** Hutt Registration District Rimutaka SD Main Hutt Road, Wellington Napier Railway, Gloucester Public Road, Chief Surveyor 29.11.1917 Approved Minister of Lands saved 30/08/2017 as IMG_
- 29 November 1917 from Chief Surveyor to Surveyor General Proposed Town of Silverstream Extension No 2 forward scheme plan recommend approval. The only new street in the Town is an extension of Gloucester Road to connect with the Main Hutt Road the new street being 100 links wide which is a sufficient width for it. All the sections have a sufficient frontage to a public road (Main Hutt Road)
- Memo laying off of Silverstream Extension No 2 (Gloucester street)
- 03 December 1917 from Surveyor General to Minister of Lands Town of Silverstream extension No 2 laying off of Gloucester Street
- 11 December 1918 from Minister of Lands authorising laying off of Gloucester Street in the Town of Silverstream
- PLAN Extension No 3 Plan of Proposed Town of Silverstream part **section 142** Hutt District Block IV Belmont SD Dunns Road - Whitemans Valley Road – J H Fyffe – J A Dunn – Wiggins – F V Evans - Chief Surveyor 23.11.1920 Approved Minister of Lands 25.11.1920 saved 30/08/2017 as IMG_
- 23 November 1920 from Chief Surveyor to Surveyor General Proposed Town of Silverstream Extension No 3 the scheme of the above proposed town is forwarded herewith for the approval of the Minister. The land owner by Mr J M Emery except section 1 which is owned by Mr Evans the owner of the adjoining Lot 17. Mr Emery had no other land in the locality and as soon as the scheme is approved proposed to build houses for permanent residence. Dunn's Road is former and has been accepted by the Hutt County Council. As the plan has been inadvertently overlooked I should be glad if you could see your way to have it made urgent
- 23 November 1920 Town of Silverstream extension No 3
(Reference Archives NZ Wellington ACGT 18190 LS1 1808 25/508 Township Silverstream year not dated)

1920-1930

1921 Town of Silverstream Section 97 & 142 & 83

- PLAN of proposed Town of Silverstream Extension No 4 being part of Section 97 Hutt Registration District Block 1 Rimutaka Survey District Hutt County W G Gard owner – Pemysey Road – Terminus Road – Recreation Reserve – Wellington Napier Railway Chief Surveyor 23/12/1921 approved Minister of Lands 14/2/1922 (1921) saved 30/08/2017 as IMG_
- 23 December 1921 from Chief Surveyor to Surveyor General Town of Silverstream extension No 1 [sic] The land is owned by Mr Gard who was the owner of a considerable portion of the adjoining land most of which has been however disposed of. The purpose of the subdivision is residential. In order to provide a site for a library a small section equal to one chain square has been set aside out of what was originally section 1. The result of this is that the frontage to sections 1 and 6 are both under 40 feet being 33 feet each. As this cannot be avoided without recasting a portion of the scheme I recommend that the Minister should be asked to approve of these two frontages. The scheme in other respects complies with requirements and is in order for approval.
- 10 January 1922 from Surveyor General to Chief Surveyor Town of Silverstream extension No 4 (noting extension No 1 above should be extension 4) It is not in order as the original town scheme approved by the Governor in 1910 shows the Reserve (Section 82) now Terminus Road extending to the Railway Reserve. This now scheme therefore overlaps and amends a scheme already approved.
- 11 January 1922 from Chief Surveyor to Surveyor General Town of Silverstream Extension No 4 I am unable to see in what way the plan can be altered except to reproduce on the face of it the boundary of the original town of Silverstream which I have done. Plan is returned
- PLAN of Proposed Town of Silverstream Extension No 5 being part **Section 142** Hutt District Block IV Belmont SD – James Abraham Dunn Owner CT 256/159 – Wellington Wairarapa Railway – Whitemans Valley Road – Dunns Road – Public Road – 2 Proposed Road – Silverstream Brick & Tile Coy (on 3 sides) – G Baskett – Plantation Reserve – W Wakeland –

- C H Fyffe – T Williams – G Hallcroft – T Kirk – surveyor Martin & Dyett 03/11/1924 Chief Surveyor 08/12/1924 Surveyor General 16/12/1924 Minister of Lands 19/12/1924 saved 30/08/2017 as IMG_
- 08 December 1924 from Chief Surveyor to Surveyor General Town of Silverstream Extension No 5 forwarding plane prepared by Messrs Martin and Dyett on behalf of owner Mr James Abraham Dunn of Silverstream meets with approval of the local Authority recommend that it be submitted to Minister for approval (only transcribed some details)
 - Town of Silverstream Extension No 5 Memo Surveyor General to Chief Surveyor
 - PLAN Proposed Town of Silverstream Extension No 6 part of section 142 Hutt District Block IV Belmont SD – Owner CT 294/173 James A Dunn – Whitemans Valley Road – Wellington Wairarapa Railway – Public Road (Kin Street) – New Road not dedicated - C H Fyffe DP 5410 CT 298/279 – T Williams CT 294/102 – The Silverstream Brick & Tile Coy Ltd CT 294/14 – Mrs K Muire CT 256/160 – C H Ritzema CT 286/300 – Mrs E E Jones CT261/68 – C A Jones CT 313/208 approved Minister of Lands 10/04/1925 Chief Surveyor 01/04/1925 saved 30/08/2017 as IMG_
 - 01 April 1925 from Chief Surveyor to Surveyor General Proposed Town of Silverstream Extension No 6 – plane prepared by Messrs Martin & Dyett on behalf of owner Mr J A Dunn of Silverstream (only transcribed some details)
 - 29 April 1925 memo from Surveyor General to Chief Surveyor return plan approved by Minister
 - 17 January 1930 Proposed Town of Silverstream Extension No 7 from Chief Surveyor to Surveyor General forward plan prepared by Messrs Beere & Seddon property owned by Professor C A Cotton proposed to reserve an access way to the Silverstream Railway Station form [sic] Field Street but at the request of the Railway Department the proposal was abandoned – recommend that it be submitted to Minster for approval
 - 30 January 1930 Proposed Town of Silverstream Extension No 7 cover sheet
 - PLAN of proposed Town of Silverstream Extension No 7 being Section 83 Block IV Belmont Survey District October 1929 – Kiln Road – Filed Street – Owner C A Cotton - County Clerk for County of Hutt approved 13/12/1929 - Chief Surveyor 17/02/1930 saved 30/08/2017 as IMG_
 - 30 January 1930 from Surveyor General to Chief Surveyor memo Town of Silverstream Extension No 7 advise plan has been approved

(Reference Archives NZ Wellington ACGT 18190 LS1 1808 25/508 Township Silverstream year not dated)

1929 Trentham Manoeuvre Map of Upper Hutt



(Reference 1929 Trentham Manoeuvre Map UH MAP 1929 IMG_4595.JPG)

St Mary's Anglican Church Silverstream



(Reference Upper Hutt Library Heritage collection St Mary Anglican Church Silverstream P2-933- 2183)

St Mary's Church is situated at 13 Terminus Street on Part Section No 97. The section lot once covered the corner of Terminus Street and Gloucester Street in Silverstream.

Part of Section No 97 consisting of 4 acres (1.6 hectares) of land was purchased from Mr G W Gard in 1919. The first St Mary the Virgin was built in 1931 for £600.

St Mary's church in Silverstream was originally mooted at a meeting on 08 November 1819 but construction was delayed by the difficulties of raising funds and the building was not completed until March 1931.

Other information recorded that St Mary's Church was built in 1928 not 1931.

St Mary's Church was built and opened in 1930-1931 then demolished in December 1978 to make way for a new church building which was opened 08 July 1979.

Further research on St Mary's church and land will be done when time permits.

1930-1940

1939 Birch-Tree Estate subdivision



(Reference UH Estate 1939 Birch Tree Heretaunga LHCC255_Arch_72807.jpg)

Birch-Tree Estate subdivision was situated on Part Section No 97. Details recorded on the plan are; Heretaunga Square, Pemysey / Pempsey Street, Coates Street, Hood Street, Elizabeth Street, York Avenue, Aoranghi Street, road to Golf Links, Main Hutt Road and the Wellington to Wairarapa Railway line.

1940-1950

1945 Section No 97 DP 13131



(Reference Alexander Turnbull Library Quick Maps website DP 13131 copy saved as IMG_3874.jpg)

Aerial view of Silverstream 2017



(Reference Lower Hutt City Council website Aerial maps 2017)

2022 Google Map showing St Mary's Church part Section 97



Owners or occupier of Section No 97

1850s absentee owner of Section No 97 George LACHLAN

0- George LACHLAN born unknown died unknown

#09 August 1856 New Zealand Company absentee Land Owner received Crown Grant

#Searched Ancestry for George Lachlan/Lachan in England = no trace

1858 owner or occupier of Section No 97 David SMITH and/or William SMITH

0- David SMITH born 1801 Kirriemuir Angus Scotland died 21 June 1883 Arowhena Canterbury New Zealand married 19-26 November 1824 Kirriemuir Angus Scotland **Isabella MCHARDIE / MCHARDY** born 1803 Scotland died 13 February 1880 Silverstream Upper Hutt

#Ship "Arab" departed England arrived 16 October 1841 Wellington New Zealand passengers David wife and 4 children 1 boy age 7 and 3 girls age 13, 12 & 3

#David Smith corporal 96th regiment reference New Zealand Spectator and Cooks Strait Guardian newspaper 13 September 1845

#Land for Sale – A Freehold Section situated in the Lower Hutt district bounded by that section let to Mr Barton. There are about 15 acres cleared and in good grass and well fenced in. The property is well situated for a dairy. Also a Leasehold of 2½ acres on that section in the possession of Mr Tucker with a House containing 3 rooms a dairy and cow shed. Apply to David Smith On the Premises River Hutt 09 March 1852 reference Pape past website Wellington Independent newspaper 20 March 1852 page 1 plus other newspapers

#David SMITH River Hutt farmer New Zealand Jury List Wellington 1859 Wellington Independent newspaper 09 April 1861 page 6

#Marriages – Carrington – Smith – 18 February [1861] at Arowhena Timaru by the Rev G Foster Frederick James only son of F A Carrington Esq., C.E. of Taranaki to Charlotte second daughter of David SMITH Esq., Upper Hutt Wellington reference Papers past website 1861

#Deaths – GILLIES On Thursday morning 18th instant at the residence of Mr David Smith Silver Stream Isabella beloved wife of Mr Archibald Gillies late of Wairarapa reference Wellington Independent newspaper 20 May 1865 page 3

#Auction Sale - On Thursday last Mr Homer sold by public auction on the premises Silver Stream Upper Hutt the steam mill plant working bullocks stationary boiler and all interests connected with the mill itself and although the day was rather unpropitious the attendance was unusually large and the bidding most spirited. The bidding started at £400 and fell into the hands of Messrs Robinson and Lawrence the former being one of the partners of the old firm for the sum of £527 10s cash. After which about 20,000 feet of sawn timber was sold and realized very good prices. All present expressed themselves as deeply indebted to David

Smith Esq., for his hospitality to both man and beast reference Papers past website Wellington Independent newspaper 04 June 1867 page 3
#David SMITH Upper Hutt Freehold Upper Hutt house and land on section 82 reference 1867-1868 Hutt Electoral Roll
#David SMITH Upper Hutt Freehold Upper Hutt house and land on section 82 reference 1869-1870 Hutt Electoral Roll
#David SMITH Upper Hutt Freehold Upper Hutt house and land on section 82 reference 1870-1871 Hutt Electoral Roll
#David SMITH Upper Hutt Freehold Upper Hutt house and land on section 82 reference 1873-1874 Hutt Electoral Roll
#Stanley is a high chestnut [horse] and was bred by David Smith of Silverstream Taita and Hutt reference Wairarapa Standard newspaper 30 September 1876 page 3 plus other newspapers 1877 – 1878
#George Smith alias Webb was charged on remand with uttering a forged cheque. David Smith farmer of Silverstream said that prisoner had been in his employment about three months. He was not related to him. Witness always paid him up cash not by cheque. The signature to the cheque produced was not in witness's handwriting. Witness had never given the prisoner any authority to sign the cheque reference Papers past website Evening Post newspaper 20 December 1878 page 2
#Isabella SMITH died 1880 New Zealand reference RGO NZ death registration 1880 folio website 1880/4448 age 76 born about 1804
#Deaths – Smith On the 13th of February at her late residence Silverstream Upper Hutt Isabella the wife of Mr David Smith reference Papers past website Evening Post newspaper 14 February 1880 page 2
#The Friends of Mr David Smith are respectfully invited to attend the Funeral of his late wife leaving residence Silverstream Upper Hutt at 10 am on Monday the 16th arriving at Scotch Church Lower Hutt at noon E Morgan Undertaker reference Papers past website Evening Post newspaper 14 February 1880 page 3
#For Sale that First Class Dairy Farm with stock and all appliances situated within five minutes' walk of the Silverstream Station. Apply to David Smith on the premises reference Papers past website Evening Post newspaper 01 March 1880 page 3
#David SMITH died 21 June 1883 New Zealand reference RGO NZ death registration 1883 folio website 1883/84 age 83 born about 1800
#SMITH children [1] Margaret 1828-1912 [2] Charlotte 1832-1911 [3] William 1834-1903 [4] Elizabeth 1837-1915 [5] Stephen 1841 [6] Alfred 1846-1895 [7] John 1848-1918

1858 owner or occupier of Section No 97 David SMITH and/or William SMITH

0- William SMITH born 28 December 1834 Kirriemuir Angus Scotland died 16 January 1903 Martinborough Wairarapa New Zealand married 21 September 1864 Upper Hutt New Zealand Isabella AITCHESON born 09 August 1840 Edinburgh Midlothian Scotland died 18 April 1915 Martinborough Wairarapa New Zealand
#William SMITH born Scotland to parents Isabella and David Smith
#13 September 1858 owner or occupier of Section No 97
#William SMITH Upper Hutt farmer New Zealand Jury List Wellington 1859
#William SMITH married 1864 New Zealand Isabella AITCHESON reference RGO NZ marriage registration 1864 folio website 1864/4089
#William SMITH Upper Hutt Household Upper Hutt Section 95 reference 1867-1868 Hutt Electoral Roll
#William SMITH Upper Hutt Household Upper Hutt Section 95 reference 1869-1870 Hutt Electoral Roll
#William SMITH Upper Hutt Household Upper Hutt Section 95 reference 1870-1871 Hutt Electoral Roll
#William SMITH died 16 January 1903 Martinborough Wairarapa New Zealand reference RGO NZ death registration 1903 folio website 1903/3038 age 68 born about 1835
#Isabel SMITH died 18 April 1915 Martinborough Wairarapa New Zealand reference RGO NZ death registration 1915 folio website 1915/3384 age 74 born about 1841

1863 & 1870 Owner or occupier of Section No 97 John MCKENZIE and/or William FRANCIS

0- John MCKENZIE born unknown died unknown

#16 February 1863 owner or occupier of Section No 97

#John MCKENZIE Hutt Road Storekeeper leasehold Hutt District 1853-1864 Hutt Electoral Roll

#John MCKENZIE Hutt Road Leasehold Hutt District house and land 1867-1868 & 1868-1869 & 1870-1871 Hutt Electoral Roll

#25 October 1870 owner or occupier of Section No 97

#Fencing Notice – To John McKenzie or the owner of part Section No 97 on the plan of the Upper Hutt. I hereby give you notice to erect half of the fence dividing your portion of No 97. If not put up within fourteen days from the date hereof I shall proceed to erect the same at your expense in accordance with the Fencing Act – William Francis – 25 October 1870 reference Papers past website Wellington Independent newspaper 25 & 27 October 1870

#John MCKENZIE Hutt Road Leasehold Hutt District house and land 1875-1876 & 1876-1877 1878-1879 Hutt Electoral Roll

AND / OR

#John MCKENZIE Hutt Road Storekeeper leasehold Hutt District 1853-1864 Hutt Electoral Roll

#John MCKENZIE South Taratahi Freehold South Taratahi 50 acres on section No 30 reference 1866-1867 & 1868-1869 & 1869-1870 Wairarapa West & Wairarapa Electoral Roll

#John MCKENZIE senior Parkhill freehold (1) Kai-o-te-atua on the Wangaehu river moiety of 700 acres (2) Greytown town acre No 52 & John McKenzie junior Parkhill leasehold Kai-o-te-atua moiety of 4226 acres 1875-1876 & 1877-1878 Wairarapa Electoral Roll

#John MCKENZIE freehold Park Hill sheep-farmer Greytown acre 52 & John MCKENZIE freehold Featherston sheep-farmer Featherston rural sections 384 to 387 reference 1880-1881 Wairarapa South Electoral Roll

#John MCKENZIE freehold Taueru sheep-farmer Greytown acre 52 & John MCKENZIE freehold Featherston sheep-farmer Featherston rural sections 384 to 387 reference 1882-1884 Wairarapa South Electoral Roll

#Death – MCKENZIE At woodlands on 28th October John McKenzie aged 75 years reference Papers past website Wairarapa Standard newspaper 29 October 1884 page 2

#The death is announced of Mr John McKenzie of Woodlands North Wairarapa one of the pioneer settlers of this district. Deceased was a native of Rosshire Scotland and he was the first to open up the mineral waters at Strathpepper Dingwall a discovery that made the fortunes of that place for the waters are leased for £1800 a year and the Spa Hotel with its 160 rooms is the constant resort of tourists and invalids. Mr McKenzie met with an accident when young which compelled him to travel through life on one leg but notwithstanding this he had a shrewd indomitable disposition that led him to fortune. He arrived in Wellington in 1851 and for several years carried on the business of a storekeeper at the Hutt. Thence he removed to Taratahi where he purchased a farm and for the last twelve years he has been sheep farming at Woodlands. About a fortnight ago he was seized with pains in his stomach and early on Tuesday morning he breathed his last at the ripe old age of 75. Mrs McKenzie and a family of one son and two daughters survive him reference Papers past website Wairarapa Standard newspaper 29 October 1884 page 2

1870 Owner or occupier of Section No 97 John MCKENZIE and/or William FRANCIS

0- William FRANCIS born 21 May 1826 Marsden Kent England died 21 November 1871 Upper Hutt New Zealand married 1854 New Zealand **Emma BENGE** born 01 September 1836 Marsden Maidstone Kent England died 1909 Kuaru Westland New Zealand

#25 October 1870 neighbour to owner or occupier of Section No 97

#William FRANCIS Upper Valley Hutt Leasehold Mungaroa Flats Upper Hutt house and land 1867-1868 Hutt Electoral Roll

#William FRANCIS Upper Valley Hutt Leasehold Mungaroa Flats Upper Hutt house and land 1870-1871 Hutt Electoral Roll

#Fencing Notice – To John McKenzie or the owner of part Section No 97 on the plan of the Upper Hutt. I hereby give you notice to erect half of the fence dividing your portion of No 97. If not put up within fourteen days from the date hereof I shall proceed to erect the same at your expense in accordance with the Fencing Act – William Francis – 25 October 1870 reference Papers past website Wellington Independent newspaper 25 & 27 October 1870

#FRANCIS 4 children [1] Sarah Ann born 1855 [2] William born 1856 Upper Hutt [3], Mary Ann born 1860 Upper Hutt [4] John born 1861 Upper Hutt New Zealand

#For more details refer to the “HVFFrancisBenge” document on my website

1876 owner of part Section No 97 Government of New Zealand for Railways Department

#Government of New Zealand on behalf of the Railway Department 07 April 1876 land taken for a railway line

1910 owner or occupier of Section No 97 William George GARD

0- William George GARD born 15 October 1849 Chelsea London England died 29 October 1927 Silverstream New Zealand married 1872 Eastbourne Sussex England **Sarah Ann HOOKMAN** born about 1853 Eastbourne Sussex England died 08 January 1920 Silverstream New Zealand (both buried St Johns churchyard Trentham Upper Hutt New Zealand)

(8 issue all Gard children born in New Zealand [1] Minnie Edith born 1875 [2] Alice Julie born 1877 [3] Rose Elizabeth born 1880 [4] Eva Emily born 1882 [5] Martha Louisa born 1884 [6] William Henry born 1885 [7] Lily Maud born 1889 [8] Ernest George born 1892)

#For additional information refer to “HVFGardHookman” document on my website
