

Section 278 District Whitemans Valley

Owners & Settlers = THOMPSON - Charles SWANSON – Richard PROUSE – James GORRIE – Andrew GORRIE

Buildings =

Subdivisions & Streets = Johnsons Road – TVL Road – Kakariki Road – Hinkley Way

Map C Hutt District No 278

- No 26566 - Receipt of Instrument 1pm 14 March 1877 – Nature of Instrument Crown Grant – Date of Instrument 04 January 1877 – Where recorded 10 Vol Grant folio 357
- No 33988 – Receipt of Instrument 2pm 20 March 1879 – Nature of Instrument Conveyance – Date of Instrument 09 February 1874 – Where recorded 56 D/of 437 – Reference Vol 32 Folio 253 – Signature Thomson
- No 47468 – Receipt of Instrument 10.30 am 12 July 1884 – Nature of Instrument Conveyance – Date of Instrument 10 February 1884 – Where recorded 81 D 454 – Reference Vol 34 Folio 510 – Charles Swanson

At bottom of page

No 26566 Richard Prouse D1785

No 33988 Jas Gorrie to Gorrie Andrew

No 47468 Prouse to Jas Gorrie

(Reference Archives NZ Wellington Archway register scanned AFIH 22394 W5691/55 volume 15 Deeds Index – Hutt, Ohariu, Pahautahi Agricultural Reserve, Wainui, Wainuiomata c1844-c1969 Wellington Folio 1 to Folio 557 record online available image 70 Map C Hutt District folio No 178)

2019 Whitemans Valley Rd, Johnsons Rd, Tvl Rd, Kakariki Way & Hinkley Way



(Reference Google Maps Whitemans Valley Road Johnsons Road, Tvl Road, Kakariki Way & Hinkley Way

Section No 278 Whitemans Valley

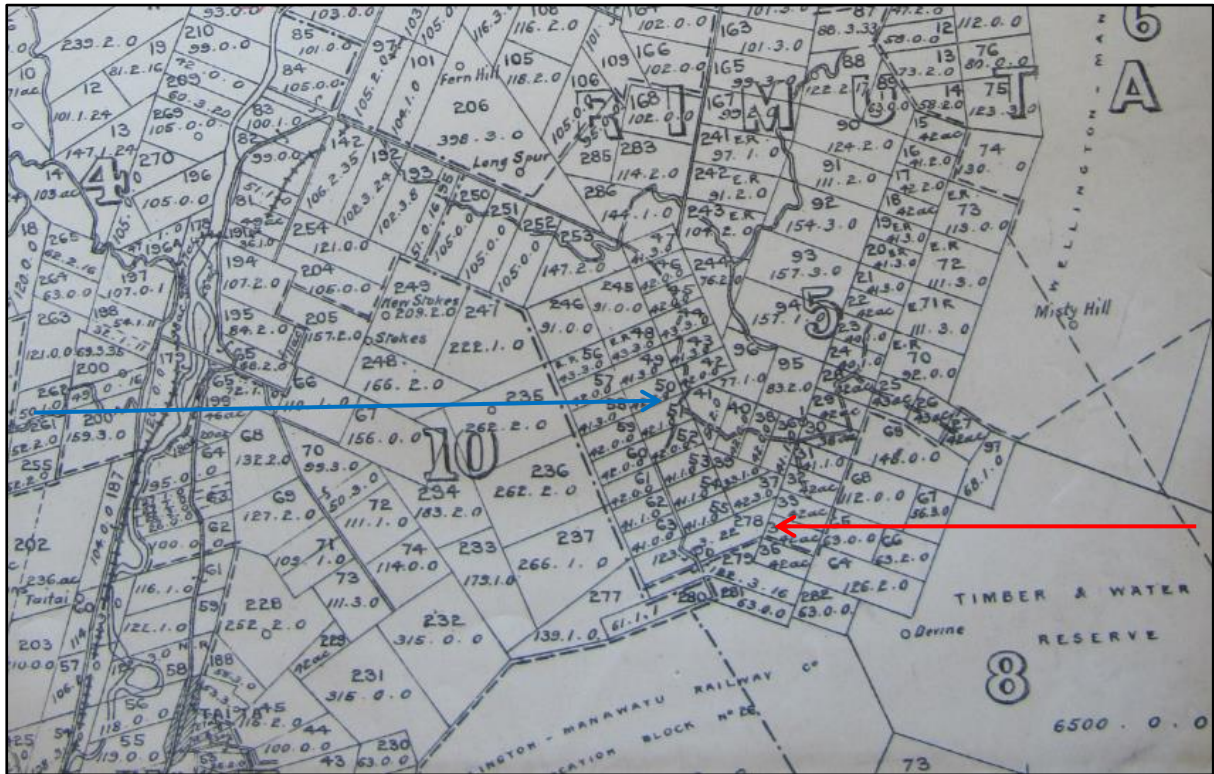

(Reference Archives NZ Wellington maps saved as IMG_1426.jpg)

Section No 278 Whitemans Valley

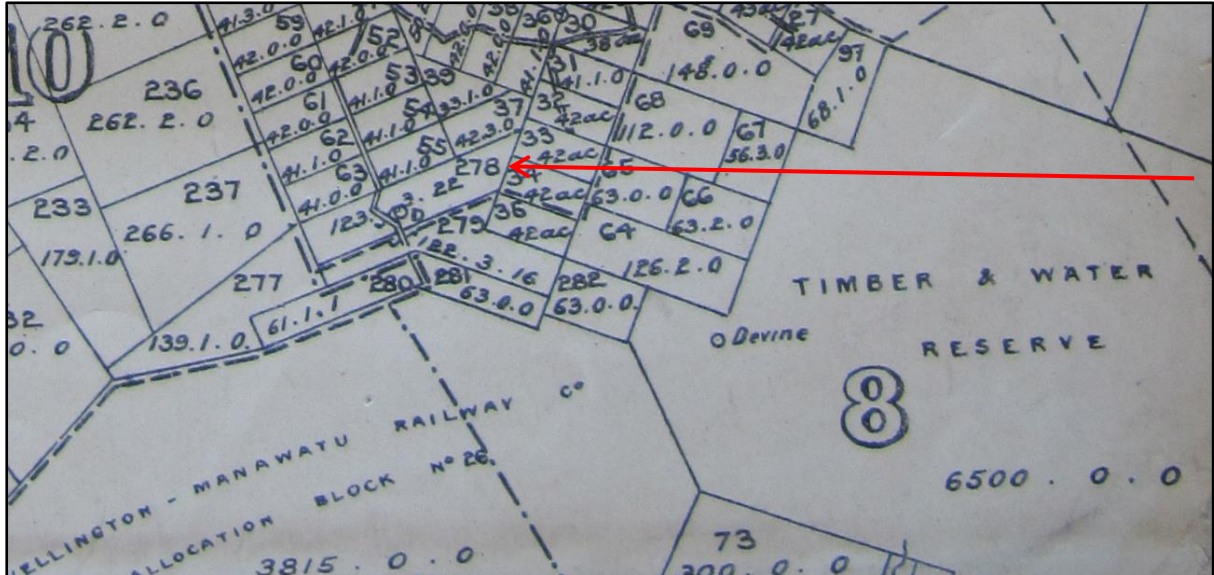

(Reference Archives NZ Wellington maps saved as IMG_1426.jpg)